

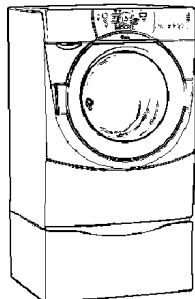

dreamspace



Service Manual

Washing machine

ACCESS

AWM 8000-E,P,GR

Model Version	AWM 8000-E,P,GR 8570 077 18000	Page
	Technical data	2 - 4
	Spare part list	5 - 6
	Exploded view	7 - 8
	Wiring diagram	9
	Circuit diagram	10
	Program chart	11 - 16
	Text/Legend	17 - 19
	Family	OMEGA Access EU

Technical data**Dimensions**

Height	96.5	cm
Width	68.6	cm
Depth	73.5	cm

Weight

Without package	108	kg
With package	110	kg

Main connection

Voltage	230	V
Frequency	50	Hz
Power consumption	2.3	kW
Fuse rating	10	A

Drum

Volume	78	l
Wash spin	35/40	rpm
Ramp spin	100	rpm
Speed spinning max.	1400	rpm

Capacity of dry laundry

Cotton/coloured laundry	8	kg
Easy care	3.5	kg
Daily	3.5	kg
Delicate	2.5	kg
Handwash	2.0	kg
Wool	2.0	kg

Pressostat for washing-machine**Level1**

Switching point	60 ± 5	mmWc
Reset	40 ± 5	mmWc

Overflow

Switching point	280 ± 20	mmWc
-----------------	----------	------

Water column drum

(measured inside of the drum, rear position)

Level1

Switching point	43 - 55	mm
-----------------	---------	----

Overflow

Switching point	248 - 314	mm
-----------------	-----------	----

Nominal current

Contacts:		
11 - 12	~ 3mA	24V DC
11 - 14	~ 3mA	24V DC
11 - 16	~ 3mA	24V DC

Contacts system:

11 - 12 - 14	jump contacts
11 - 16	slow action contacts

Door lock**Nominal current:**

contacts		
4 - 5	16 A	230V
6 - 7	16 A	230V
8 - 9	0.1 A	230V

Coil 1 - 2 and 2 - 3 :

Nominal voltage	230	V
Frequency	45 - 65	Hz
Resistance 1 - 2 (lock)	133 ± 10%	Ω
Resistance 2 - 3 (unlock)	140 ± 10%	Ω
Locking time	40 ± 10	ms
Unlocking time	1	s
(max.6 cycles)		

Heating element

Kind of heating	Tubular heating element with NTC- Sensor	
Nominal voltage	230	V
Nominal power	2050	W
Heat conductor resistance R25	22 - 28	Ω

Resistance NTC:

0 °C	35.9	kΩ
30 °C	9.8	kΩ
40 °C	6.6	kΩ
50 °C	4.6	kΩ
60 °C	3.2	kΩ
70 °C	2.3	kΩ
95 °C	1.1	kΩ

Inlet valve

Water temperature max.	60	°C
Rated flow > 1 bar	8	l/min
Pressure range	0.5 - 10	bar
Nominal voltage	220/240	V
Frequency	50	Hz
Starting voltage		
< 6 bar	160	V
6 -10 bar	170	V
Nominal current	35	mA
Nominal power	6	VA
Nominal resistor (20 °C)	3.4 - 4.5	kΩ

Technical data

Floater

Nominal current	5	V DC
Nominal power	~1	mA
Switch energy	< 15	cN

Drain pump (synchronous)

Nominal voltage	220(-15%)-240(+6%)	V
Nominal current	0.35	A
Nominal consumption	45	W
Frequency	50 ± 3	Hz
Resistor (coil)	98 ± 7%	Ω
Motor protection	yes	
Capacity (1.25m height)	31 ± 2	l/min

Flowmeter

Nominal voltage	5	V
Nominal current:		
nominal	1	mA
maximal	20	mA
Pressure area	0.5 - 10	bar
Line to be recognized	195 - 215	pulse/l
Frequency signal	3.25 - 36	Hz

Distribution actuator

Motor:		
Nominal voltage	230 +10%, -15%	V
Nominal current	13	mA
Nominal resistance(20°C)	6.5 ± 10%	kΩ
Contacts:		
Nominal current	1	mA
Nominal voltage	24	V

Electronic complete

Basic	4619 702 10481	
Programmed	4619 702 12951	
Nominal voltage	230	V
Frequency	50	Hz
Detergent Dispenser	4 Chambers	
Programmes	12	
Cold fill	yes	
Flowmeter	yes	
Speed	1400	rpm
Ambient temperature	up to 70	°C
Storage temperature	up to 85	°C

Program

1.	White cotton
2.	Coloured cotton
3.	Easy care
4.	Daily load 40°
5.	Rapid plus
6.	Delicate
7.	Wool
8.	Handwash
9.	Drain
10.	Gentle spin
11.	Spin
12.	Rinse & Spin

Output

Aquastop (activated)	AQ2.2 - (Vcc)	24 V
Pump (on)	DP2.1 - DP2.2	230 V
Valve cold (on)	VCH7.1 - VCH7.3	>170 V
Valve hot (on)	VCH7.5 - VCH7.7	> 170 V
Heating (on)	HE2.1 - HE2.2	230 V
Motor distributor (on)	DI6.1- DI6.3	230 V
Pressostat	PR6.4 - (Vcc)	24 V
- empty	PR6.6 - (Vcc)	24 V
- full (L1)	PR6.5 - (Vcc)	24 V

Motor

Type	CIM 2/55-232/WHE1
	i = 1:12.1

Resistance contacts:

1 - 2	3.4	Ω ± 7%
1 - 3	3.4	Ω ± 7%
2 - 3	3.4	Ω ± 7%
4 - 5 (Tachometer)	115.4	Ω ± 7%

Radio interference supression

Nominal voltage	230	V
Nominal capacity	1 μ F X1 + 2 x 0.22 nF Y	
Nominal inductance	2 x 1	mH
Nominal resistance	470	kΩ

Motor control unit (MCU)

Fac. code	4619 703 10611
Supply	L and N 230 V/50 Hz

Technical data

Display module

Fac. code	4619 702 11231
Programmes	12
Remaining time indication	
Switch Start	SST
Switch Time delay	STD
Switch Pre wash	SPW
Switch Temp. choose	+/-
Switch Rinse intensive	SRI
Switch Rinse stop	SRS
Switch Spin speed reduction	SSR
Switch Easy ironing	SEI
Child lock	
Reset	

Spare part list

Model **AWM 8000-E,PGR**
Service No. **857007718000**
Version **857007718000**

Pos. No.	12NC Code	Description
001 0	4812 440 10625	Cabinet
003 1	4812 464 48162	Traverse rear
003 2	4812 464 48163	Traverse table top
003 3	4812 464 48176	Traverse transport
003 4	4812 464 48164	Brace, side
004 0	4812 440 10623	Drip tray assy
011 0	4812 462 18261	Adjust.foot
021 0	4812 440 10807	Front, panel white
021 3	4812 440 98136	Cover, hinge
021 5	4812 404 78466	Clip for Shield
021 6	4812 440 98154	Shield cpl.
024 0	4812 440 10788	Panel, rear
025 0	4812 440 10789	Bracket control board
025 1	4812 440 10791	Water guide
030 0	4812 440 10626	Table top white
040 0	4812 417 19179	Hinge cpl.
040 1	4812 417 78091	Cover Hinge WH
050 0	4812 459 38061	Plinth white
061 0	4812 466 88595	Counter weight rear
061 1	4812 466 88706	Counter weight front
081 0	4812 466 48092	Shock absorber
086 0	4812 452 18994	Screw M8x20 A2F
086 1	4812 502 18399	Nut Push in M 8
110 0	4812 498 18274	Handle, door foam
110 1	4812 498 18236	Handle, door cpl.
130 0	4812 417 28086	Plate door lock
131 0	4812 417 28087	Lock hook door
135 1	4812 498 18264	Pin door safety
135 2	4812 492 58044	Spring doof safety
135 3	4812 532 18068	Washer door safety
140 0	4812 450 78019	Door glass
143 0	4812 440 11117	Glassdoor frame + Protector blue
144 0	4812 440 10834	Frame, door glas
144 1	4812 401 48585	Clamp door glass
144 2	4812 560 18068	Screw DIN 7500, CM 5x14
144 3	4812 502 48015	Screw 4,0x16-TORX
191 0	4812 310 18865	Door bellow grease resistant KIT
191 1	4812 401 18619	Strap bellow, tub
191 2	4812 401 18621	Ring bellow front
200 1	4812 418 18405	Tub, half front
200 2	4812 418 18449	Tub, half rear cpl.
200 4	4812 290 88054	Clamp for tub
220 0	4812 418 18403	Drum
221 0	4812 466 68736	Deflector
223 0	4812 418 48573	Drum lifter
271 0	4812 358 18187	Belt J7
272 0	4812 528 58037	Pulley
272 1	4812 532 28941	Nut M16 f.pulley, drum
290 0	4812 532 68124	Gasket tub
301 0	4812 452 11758	Control panel AWM 8000, Symbole
301 1	4812 452 12276	End cap left
301 2	4812 452 12277	End cap right
303 0	4812 498 78239	Handle, drawer 6.SENSE
321 0	4812 452 11738	Insert rear Knob
321 2	4812 452 11737	Filling piece door

Pos. No.	12NC Code	Description
321 3	4812 459 18237	Sticker WH-Logo
331 0	4812 413 18286	Knob with spring
332 1	4812 410 28963	Button Start Delay
332 2	4812 410 28967	Button assy +/-
332 3	4812 410 28965	Button assy Option 3x
332 4	4812 410 28964	Button assy Option 4x
333 0	4812 410 28966	Button Start
400 0	4812 361 58351	Motor 3-phases
421 0	4812 121 18142	Interf.filter 1,00 µ F
430 0	4812 360 18524	Pump
430 1	4812 466 68757	Damper rubber gear
430 2	4812 466 68758	Damper rubber front
451 0	4812 259 28758	Heating element 2050W + NTC
451 1	4812 401 18622	Fastener heating element
451 2	4812 560 18069	Screw MP 1951, M4x14 SS
480 0	4812 321 78152	Cable harness motor
480 1	4812 321 78154	Cable harness main
480 2	4812 321 78153	Cable harness valve
490 0	4819 321 18136	Cable,mains 2m SA
491 0	4812 321 28367	Strain relief
491 1	4812 502 38152	Screw 4.8x19
521 0	4812 214 58101	Control board
521 1	4812 214 78867	Control unit motor
571 0	4812 281 28429	Inlet valve single
581 0	4812 271 28504	Pressostat
582 1	4812 271 18011	Meter, flow OMEGA/ACCESS
620 0	4812 276 28404	User board CUIO
630 0	4812 280 58041	Door lock
631 0	4812 360 58336	Floater Kit Access Europe
691 0	4812 282 18702	Sensor NTC (SC1,OMEGA PL,ACC.)
701 0	4812 530 28781	Hose, inlet 3.8 m (Eltek)
701 0	4819 530 28926	Hose, inlet 2.5 m (Eltek)
702 1	4812 530 29276	Hose Ypart, dispenser
702 2	4812 530 29192	Hose flowmeter
703 0	4812 530 48625	Hose box to bellow
707 0	4812 526 48158	Nozzle distribution
707 1	4812 526 48159	Nozzle inlet cold with Ypart
707 2	4812 630 58102	O-Ring 8,1 x 1,6 mm
707 3	4812 526 48161	Nozzle window rinse
707 4	4812 526 48162	Nozzle inlet window rinse
707 5	4812 530 78011	Washer edge disc
708 0	4812 530 48626	Bend
711 0	4812 418 68291	Dispenser
712 0	4812 418 89012	Drawer detergent
713 0	4812 418 89013	Hook drawer
714 0	4812 418 79819	Container detergent
717 0	4812 323 18006	Actuator f. Distribution
717 3	4812 321 38026	Lever connection
717 4	4812 321 38027	Lever distribution
717 5	4812 528 38069	Cam actuator
717 6	4812 492 58045	Spring f. lever
717 7	4812 502 18623	Screw PT3,5x20-TORx20
718 0	4812 526 48139	Siphon
718 1	4812 418 88994	Separator set
753 0	4812 418 68292	Chamber, air

Spare part list

Model AWM 8000-E,PGR
Service No. 857007718000
Version 857007718000

Pos. No.	12NC Code	Description
754 0	4812 530 29278	Drainhose
754 1	4812 530 29279	Lock eco ball
754 4	4812 401 18623	Clamp 98,5 mm
760 0	4812 480 58294	Filter set pump
760 1	4812 466 88707	Gasket filter
781 0	4812 530 29281	Hose, draining
781 1	4812 530 29282	Hose, connection outlet
782 0	4812 530 29196	Hose pressostat,with protector
783 4	4812 530 29284	Hose, draining inner
787 0	4812 530 28813	Steam hose
787 1	4819 401 18868	Clamp, hose 26.8 mm
787 5	4812 401 18624	Clamp 52,0 mm
794 2	4812 530 58164	Sealing
794 5	4812 530 58098	Gasket Airtrap
900 0	4812 255 18204	Holder Hose outlet
900 1	4822 401 10492	Clamp, hose 14-24 mm
900 2	4812 401 18501	Clamp, hose 19.2 mm
900 3	4812 401 18626	Clamp 32,7 mm
900 4	4812 401 18627	Clamp 40 mm
900 6	4812 255 18249	Holder drainhose inner
910 0	4812 502 48344	Screw
910 1	4812 502 18624	Screw 3.5x10-F A2F
910 2	4812 502 38352	Screw 4x10
910 4	4812 930 08022	Screw 4.2x13-F-H
910 5	4812 502 18382	Screw M8 X 35
910 6	4812 502 38355	Screw 4,2x16 T20
910 7	4812 502 18635	Screw 4.2x9.5
921 0	4812 011 18525	Ring, circlip f. driver system
930 0	4812 492 38387	Spring, suspens.
930 1	4812 492 38388	Silent bloc
941 0	4812 520 28183	Bearing,ball 6307
941 1	4812 520 28004	Bearing,ball 6206
952 1	4812 524 48014	Bushing f. shaft seal
953 0	4812 530 68029	Shaft seal
961 0	4812 310 18831	Distance sleeve upper
961 1	4812 310 18832	Distance sleeve lower
962 1	4812 466 38033	Cover motor
965 0	4812 466 68812	Cover
965 1	4812 262 78011	Threaded cap tub rear part
993 0	4812 530 29095	Bow
993 3	4812 395 58004	Tool

Exploded view

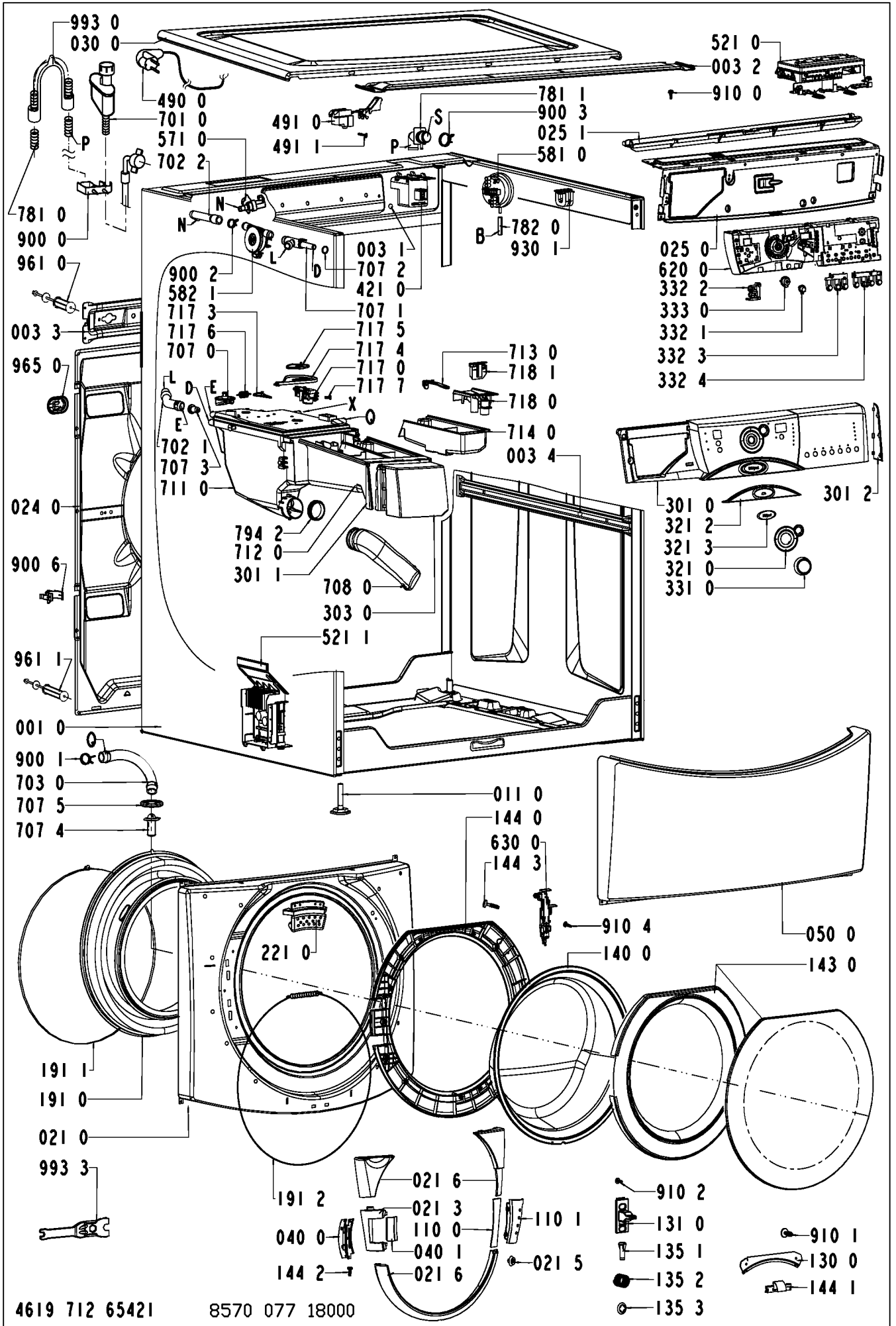

Exploded view

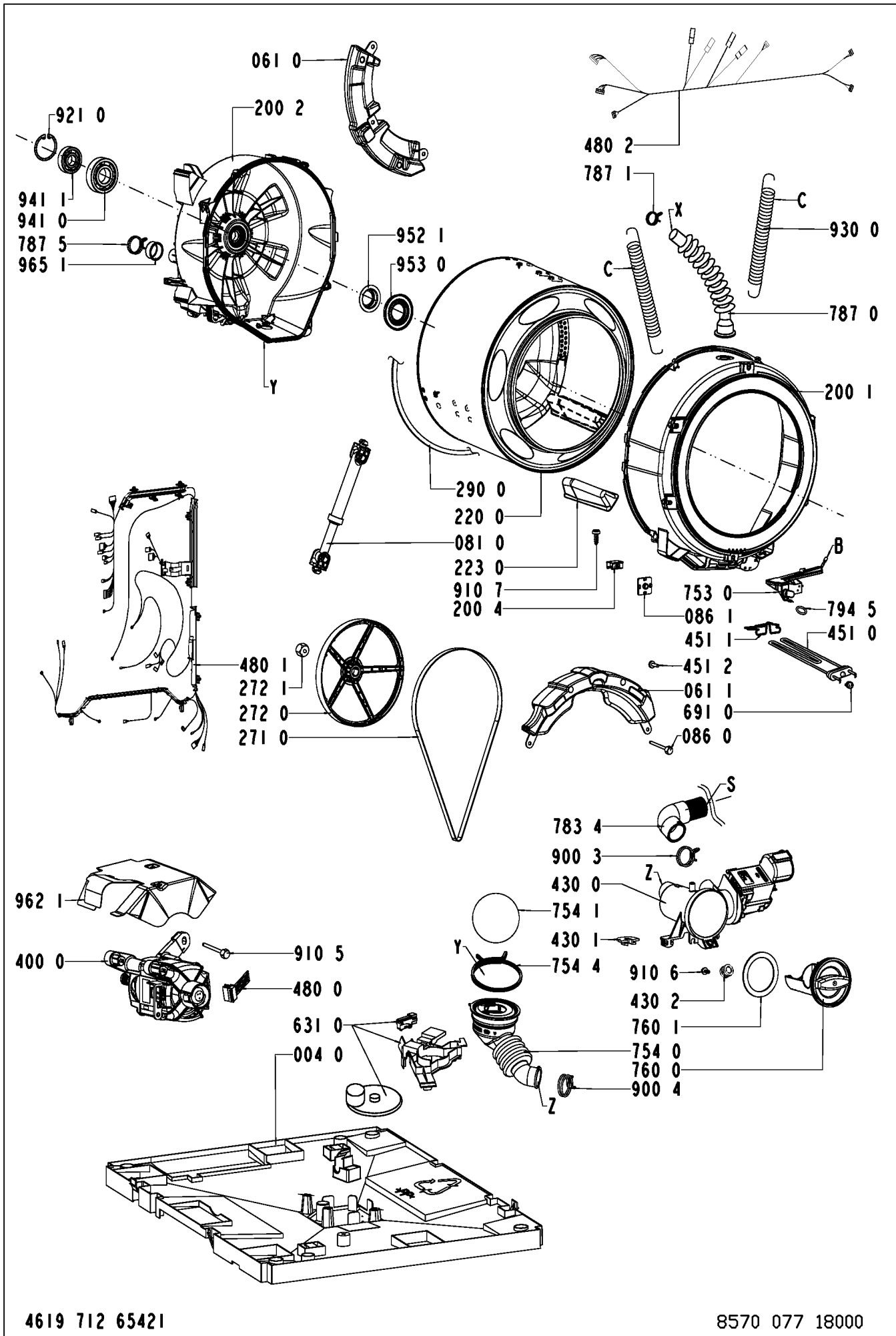

Wiring diagram

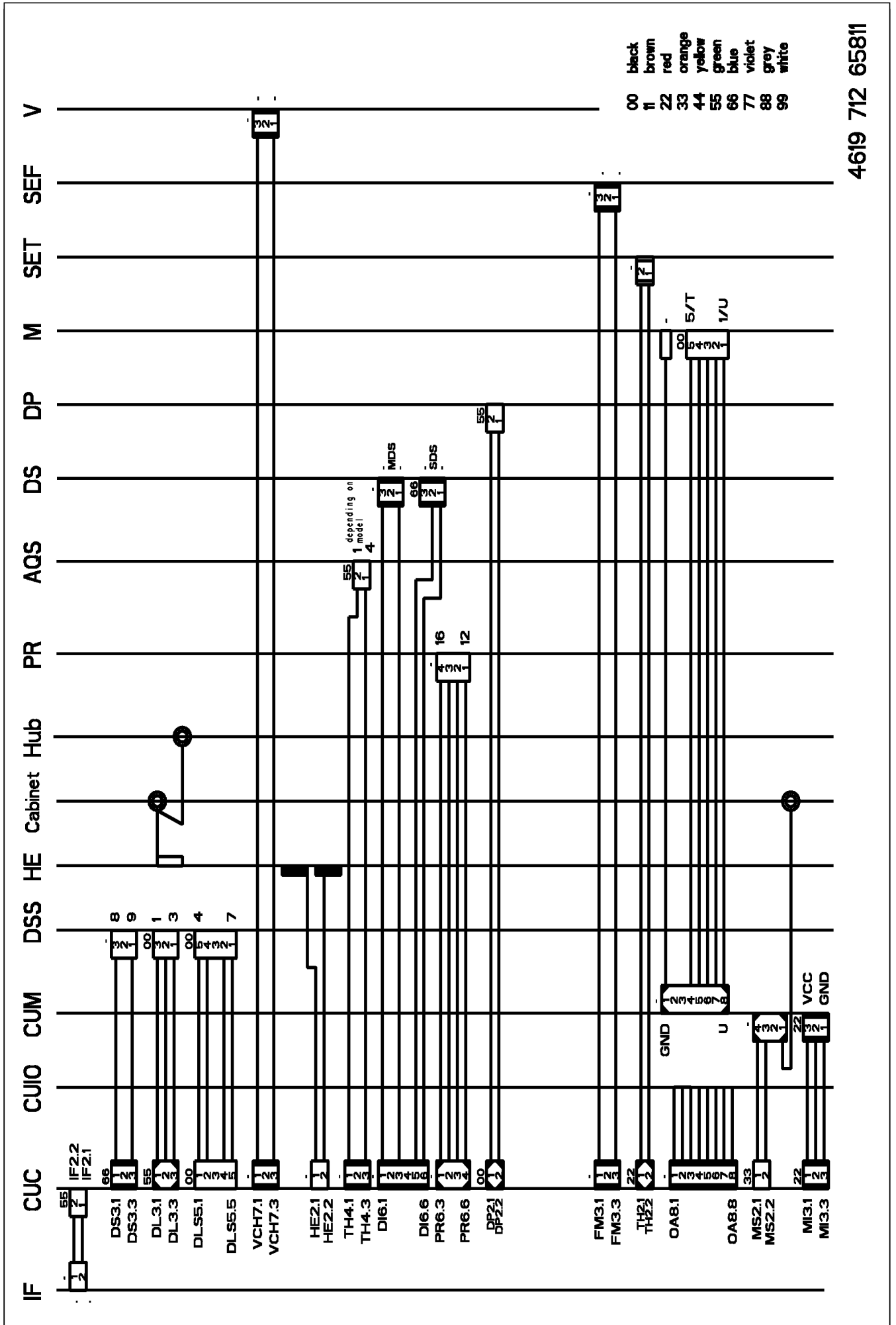

Circuit diagram

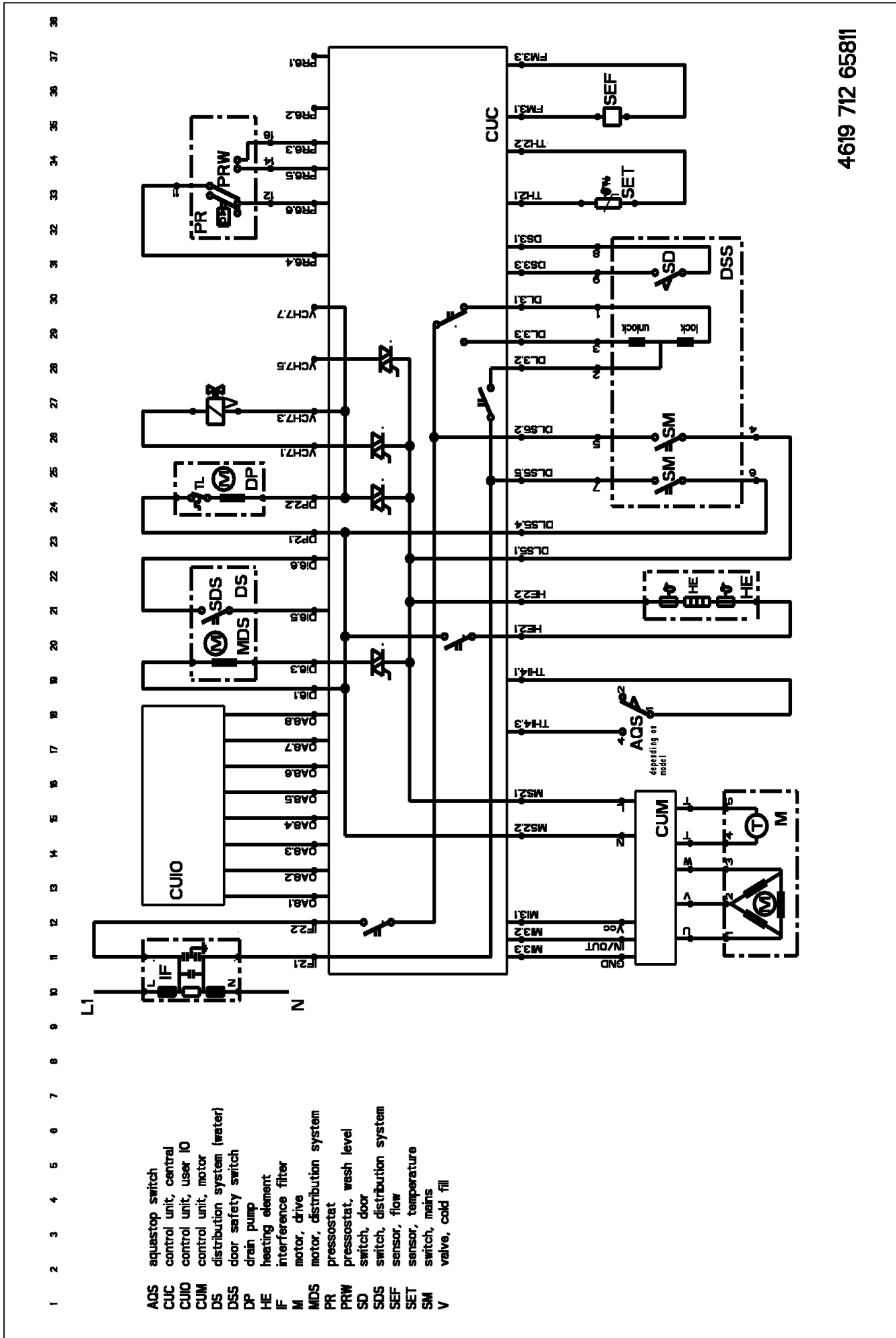

4619 712 65811

Program chart

4619.703.11371

Soap dispenser: 4 (3) chambers

Wash Cycles/Spin Cycles

OMEGA Access EU

Cotton

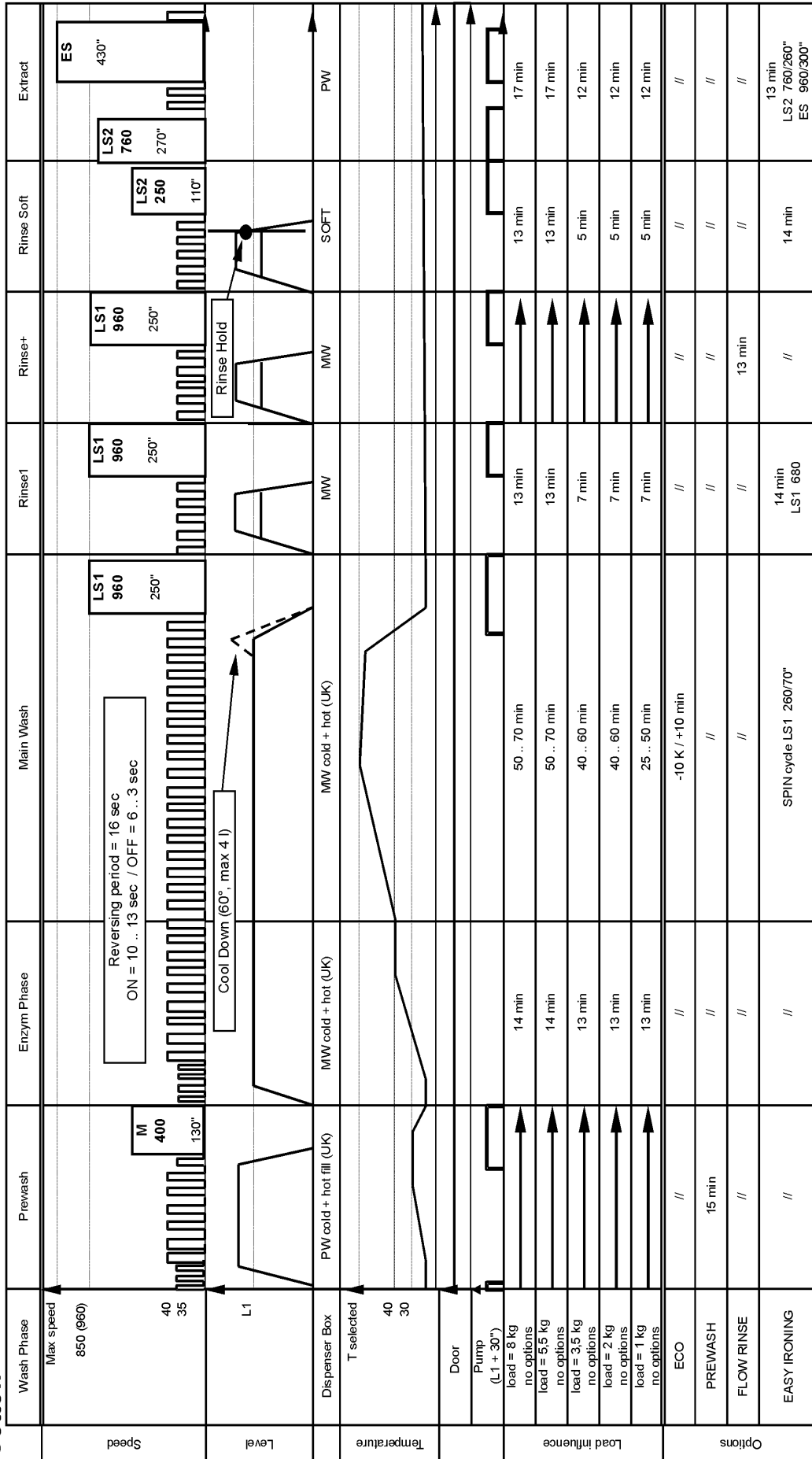

// the program step is not influenced by this option

↑ the program step is skipped by this option

Program chart

4619.703.11371

Soap dispenser: 4 (3) chambers

Wash Cycles/Spin Cycles

Easy Care

Wash Phase	Prewash	Enzym Phase	Main Wash	Rinse1	Rinse+	Rinse Soft	Extract
Speed	960 850						
Level	M 400 130"	Reversing period = 16 sec ON = 10 .. 13 sec / OFF = 6 .. 3 sec	LS2 400 80"	LS3 760 130"	LS3 760 130"	LS3 680 140"	LS4 960 240"
Temperature	PW cold + hot fill (UK)	MMW cold + hot fill (UK) T max = 60°	MMW cold + hot fill (UK)	MMW	MMW	SOFT	PW
Options	Dispenser Box T selected 40 30	Door Pump (L1 + 30") Cycle EASY CARE load <1kg no option	15 .. 17 min // // -10 K / +10 min // Spin: LS1 256°	10 .. 11 min // // more water Spin: LS3 680	11 .. 12 min max 960 rpm // // //	8 min // // //	LS3 680/140" LS3 760/140"
Short Cycles	PREWASH EASY IRONING FLOW RINSE	15 min // //	Duration: 4 min Max Temperature: 30° Spin: LS1 960/250°	10 .. 11 min	11 min	6 min	Duration: 7 min SP2 1360/280"
	RAPID PLUS Express 30 / 30 CHROMO 60	13 min 15 .. 17 min	Duration: 24 ... 28 min Max Temperature: 60° Spin: LS1 960/220°	10 .. 11 min	6 min	6 min	Duration: 7 min SP2 1360/280"

Program chart

4619 703 11371

Soap dispenser: 4 (3) chambers

Wash Cycles/Spin Cycles

Delicate

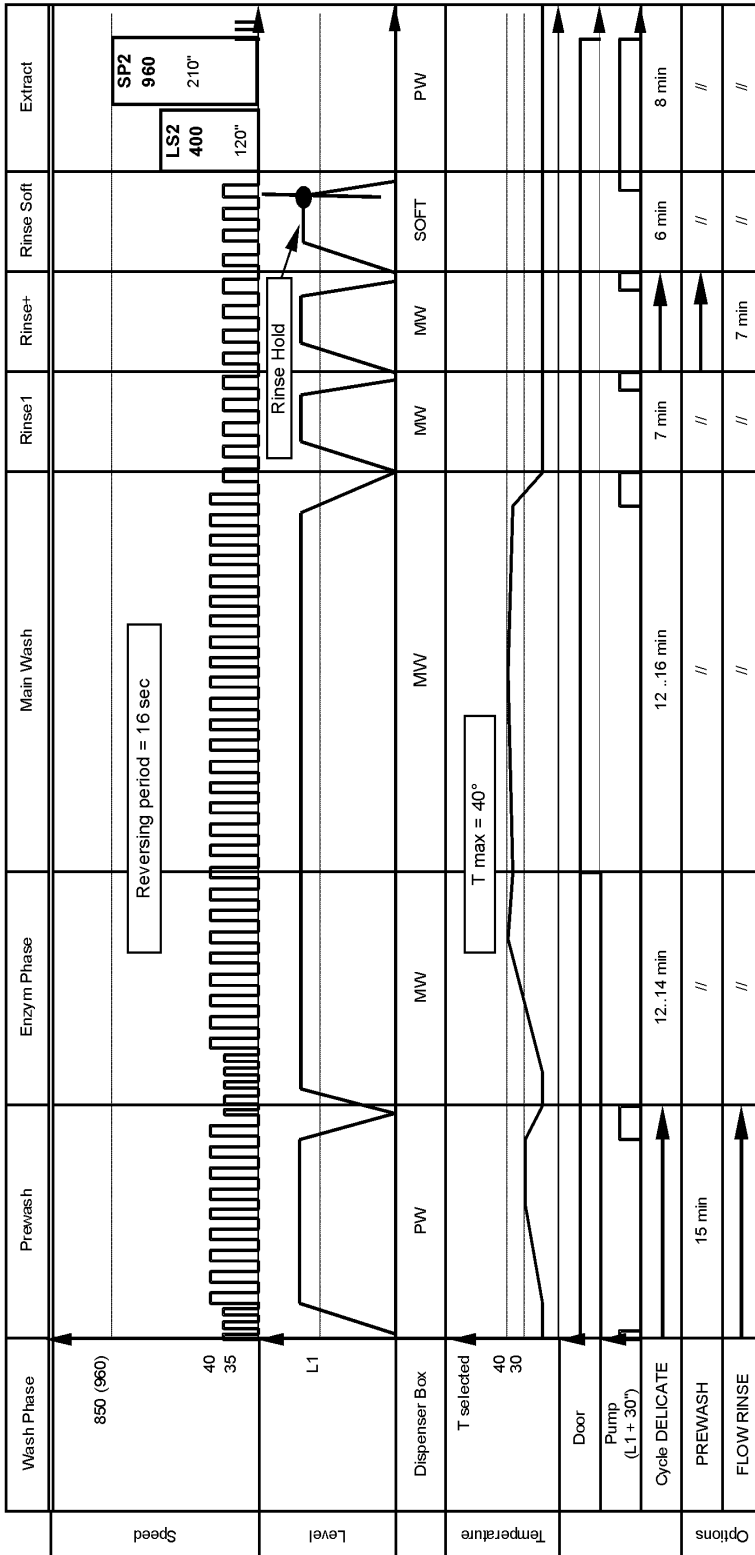

Program chart

OMEGA Access EU **Wash Cycles/Spin Cycles** Soap dispenser: 4 (3) chambers **4619 703 11371**

Wool

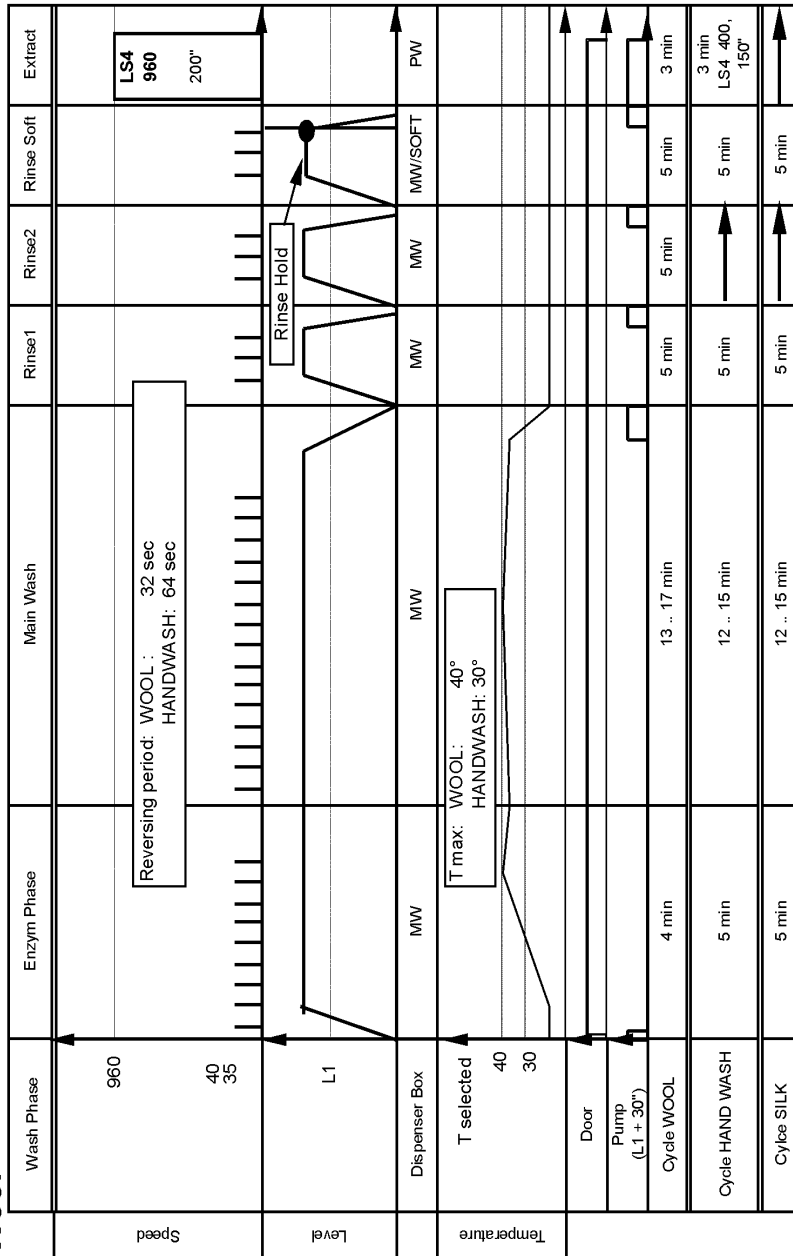

Reversing period: ON = 1.5 sec / OFF = 30 ... 62 sec

Program chart

4619 703 11371

Soap dispenser: 4 (3) chambers

Wash Cycles/Spin Cycles

OMEGA Access EU

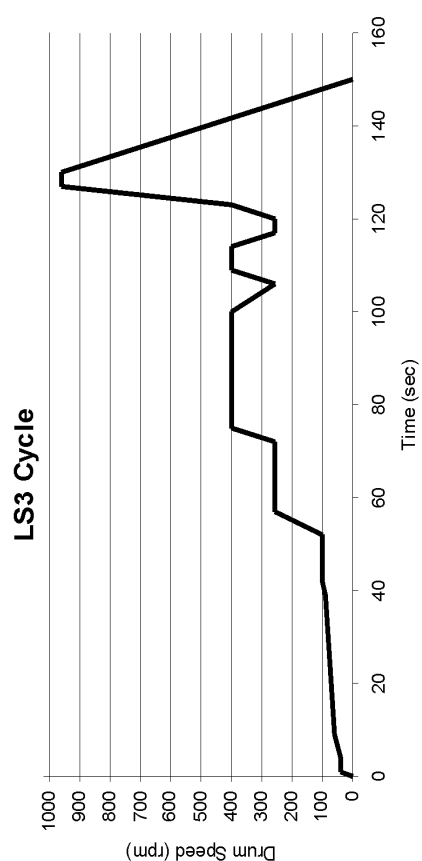
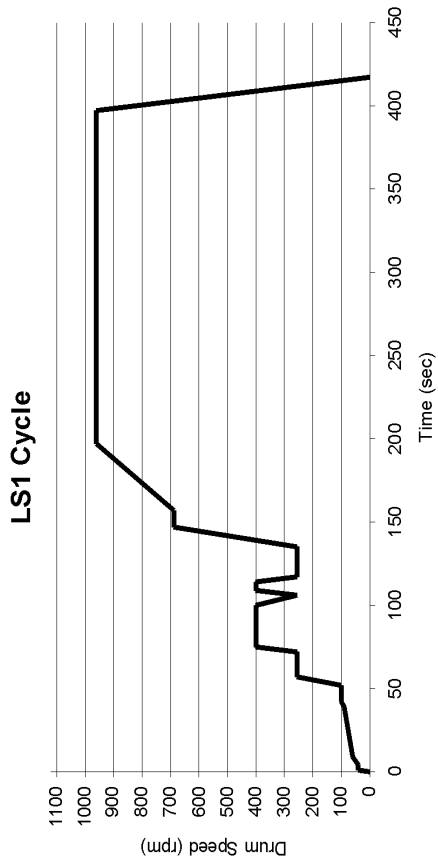
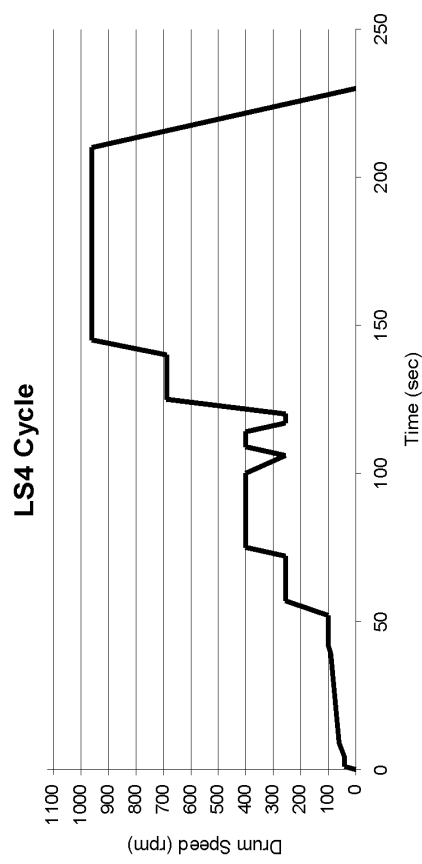
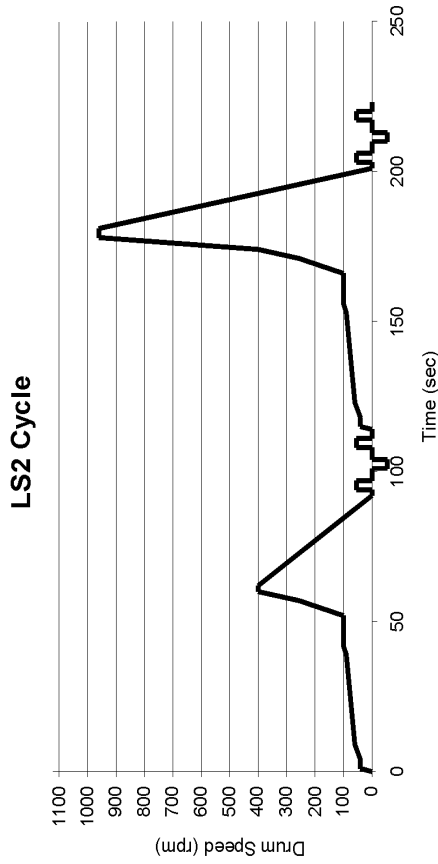

Program chart

4619 703 11371

Soap dispenser: 4 (3) chambers

Wash Cycles/Spin Cycles

OMEGA Access EU

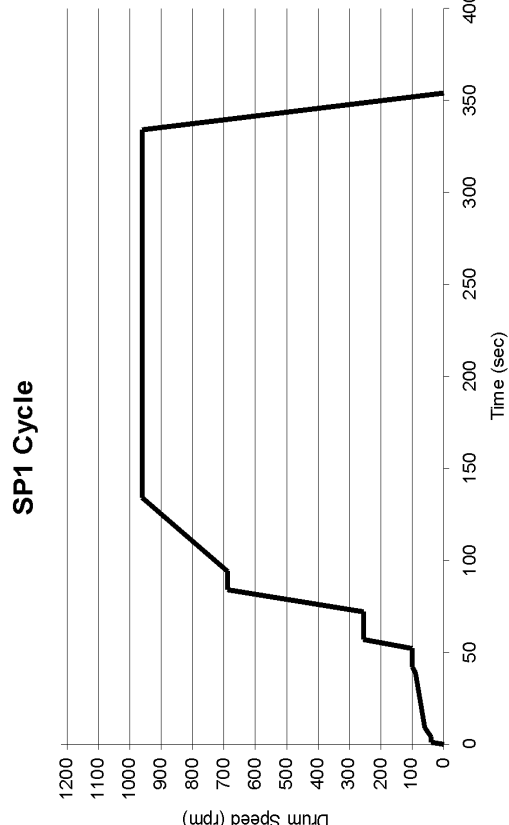
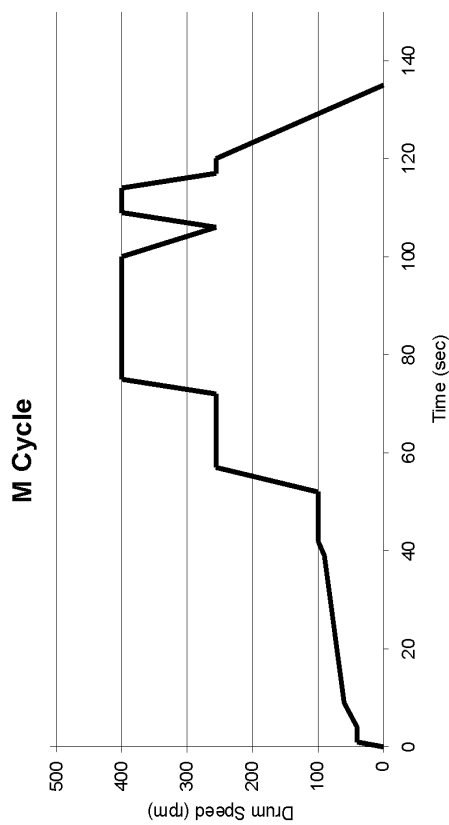
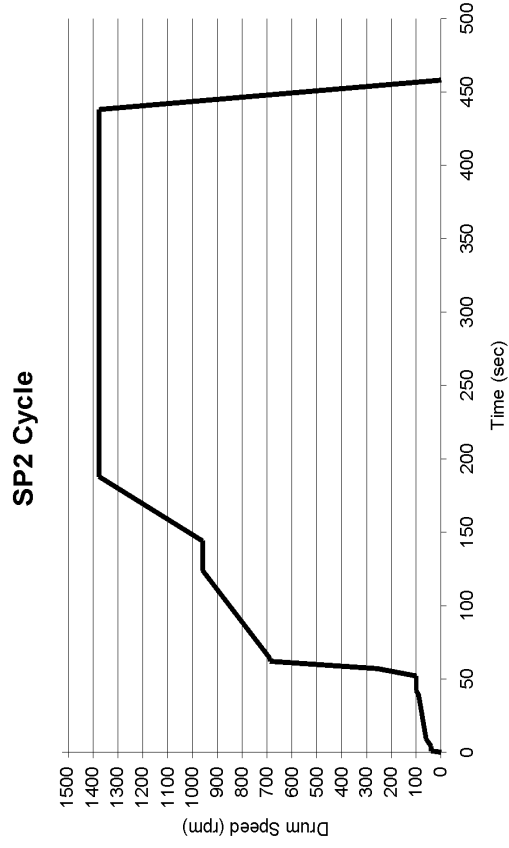
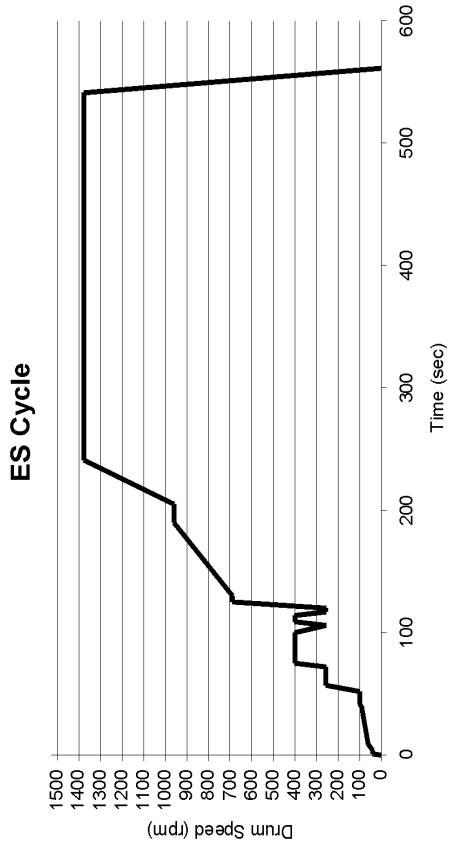

Text/Legend

OMEGA Access EU Test Program 4619 703 11371

- | | | | | | | | | |
|------------------------|---|--|------------------|-------------------------------|-----------|----|------------------------|----------|
| 1 | → Select program
(SEMI / HEAVY DUTY) | Drain
Drain / Spinning and reduce spin speed to 0) | | | | | | |
| 2 | → Start test program | Push prewash option 4 times within 5 seconds | | | | | | |
| 3 | → Indication elements | <table border="0"> <tr> <td>DIGITS remaining</td> <td>Indicate current program step</td> </tr> <tr> <td>LED start</td> <td>ON</td> </tr> <tr> <td>LED prewash/wash/rinse</td> <td>FLASHING</td> </tr> </table> | DIGITS remaining | Indicate current program step | LED start | ON | LED prewash/wash/rinse | FLASHING |
| DIGITS remaining | Indicate current program step | | | | | | | |
| LED start | ON | | | | | | | |
| LED prewash/wash/rinse | FLASHING | | | | | | | |
| 4 | → Go to next step | Push prewash option twice | | | | | | |
| 5 | → Finish test program | Move the program selector from the DRAIN position | | | | | | |

Attention: Use the test program only without laundry !

Remaining Time	Function	Duration	Check	Drum Rhythm
C0	Lock the door Initialize MCU	Until the door is locked	Door Lock Function, Motor Control Unit (MCU)	
C1	Fill, current dispenser position	Until L1 is reached	Flowmeter, Valve Cold, Pressostat	
C2	Move dispenser motor to prewash		Dispenser Motor	
C3	Fill (cold + hot)	L1 + 30"	Valve Hot (if hot fill appliance)	
C4	Movement	30"	Motor, MCU	Drum CW 35 rpm
C5	Wash + Heat	max 50° + 1 min	Heater, NTC, Motor, MCU	Drum CW 35 rpm
C6	Drain	L1	Drain Pump, Motor	Drum CW 35 rpm
C7	Ramp	15"	Motor, MCU	Drum CCW Ramp 35 - 90 rpm
C8	Spin (max speed)	240"	Motor, MCU	Drum CCW max speed

If failure occurs: The test program is stopped
 Buzzer will beep
 Speed LEDs are flashing
 Failure Code indicated on remaining time digits

Text/Legend

OMEGA Access EU		Test Program	4619 703 11371
Display	Failure Description	Verify	
FH	<p>No water inlet detected or pressostat trip not detected. If after 30 seconds the control does not detect water entering machine the valves will be turned off and the error code will be displayed. Or If the control has turned the water valves on after 8 minutes the flow sensor has detected 48 liters of water passing through it, but has not detected the pressure switch trip, the valves will be turned off and the error code will be displayed.</p>	Water source opened Valve operation Wiring to Valves Drain Pump Flowmeter Pressostat Hoses	
FP	<p>Long Drain Error If the drain time exceeds 8 minutes, the drain pump is turned off and "FP" is flashing.</p>	Foreign objects in the Drain Pump Drain Pump Drain Hose Wiring to Drain Pump	
FA	<p>Aquastop Error If the aquastop switch is activated during the running program.</p>	Aquastop Switch	
F05	<p>NTC Error If during the water heating step in the wash cycle, the water temperature sensor (NTC) value is out of range, the "F05" error code will be displayed.</p>	NTC connections to NTC	
F06	<p>Drive Motor Tachometer Error The control board is unable to properly detect motor speed and the machine will shut down. If a failure occurs during high-speed spin the door will be unlocked after 3 minutes.</p>	Drive Motor MCU Harness to the Motor	
F07	<p>Motor Control Unit (MCU) Error The control board has detected a short circuit in the motor control unit. If a failure occurs during high-speed spin the door will be unlocked after 3 minutes.</p>	MCU	
F08	<p>Heating Element Disturbance in wiring - open circuit.</p>	Heating Element Control Board Wiring	
F09	<p>Overflow Condition If the overflow contact on the pressostat is closed for more than 60 seconds an overflow condition will be detected. In an overflow condition, the door will remain locked, and the drain pump will run constantly, even if PAUSE/CANCEL is pressed twice and the display is cleared. Unplug the unit to service.</p>	Valve operation Flowmeter Pressostat Drain Pump operation Hoses	
F10	<p>MCU/Heat Sink Thermal Trip If the thermal protector on the MCU heat sink gets too hot, it will open the thermal protector. The motor functions will be stopped and "F10" is displayed.</p>	MCU Motor Ambient temperature Placement of appliance	
F11	<p>Communication Error Control Board-MCU If the control board unit is unable to transmit data to the MCU.</p>	Control Board MCU Wiring to MCU	
F12	<p>Heating Element The heating element has either a short circuit to ground or the heating relay on the control board is stucked closed.</p>	Heating Element Control Board	
F13	<p>Dispenser Circuit Error If the dispenser motor is not able to be driven to it's proper position.</p>	Dispenser actuator Wiring to actuator	
F14	<p>EEPROM Error</p>	Control Board User Board Wiring to User Board	
F15	<p>Motor Control Unit (MCU) Error If the MCU detects multiple resets or errors during a wash cycle it will go into this error mode.</p>	MCU	
F21/F22	<p>Communication Error Control Board-User Board If the user board is not able to transmit/receive data to the control board.</p>	Control Board User Board Wiring to User Board	
FdL	<p>Door Lock Error A door lock error occurs if the door cannot be locked. The control board will try to lock it 6 times before displaying the error.</p>	Door Lock actuator Wiring to Door Lock Door Lock mechanics	
FdU	<p>Door Unlock Error A door unlock error occurs if the door cannot be unlocked. The control board will try to unlock the door 6 times before displaying the error.</p>	Door Lock actuator Wiring to Door Lock Door Lock mechanics	

Text/Legend

OMEGA Access EU

Terminal Connecting Plan

4619 703 11371

