

MECHANICAL PARTS LIST 1 / 1

REF. NO.	PART NO.	KANRI NO.	DESCRIPTION	REF. NO.	PART NO.	KANRI NO.	DESCRIPTION
1	8B-NFY-008-010		WINDOW, CASS 2	26	87-NF4-217-110		HLDR, LOCK 2
2	8B-NFY-007-010		WINDOW, CASS 1	27	8B-NFY-002-010		PANEL, TRAY
3	8B-NFY-004-010		BOX, CASS 2	28	8B-NFY-017-110		PANEL, CD
4	8B-NFY-003-010		BOX, CASS 1	29	87-CE3-023-010		BADGE, AIWA 30N SILV
5	8A-NF8-281-010		SPR-T, EJECT 1	30	87-NF4-221-010		HLDR, CABLE
6	8A-NF8-282-010		SPR-T, EJECT 2	31	8A-NF9-211-010		HLDR, PWB PT HI<EXCEPT 510LH>
7	8B-NFY-005-010		WINDOW, DISP U	31	8A-NF7-225-010		HLDR, PWB PT 85S<510LH>
8	8B-NFY-006-010		PANEL, FR<310U>	32	87-A80-157-010		AC CORD ASSY, E BLK CC<EXCEPT 310U>
8	8B-NFY-038-010		PANEL, FR 510<510LH>	32	87-A80-149-010		AC CORD ASSY, U BLK<310U>
8	8B-NFY-021-010		PANEL, FR E RDS<315EZ>	33	87-085-185-010		BUSHING, AC CORD (E)<EXCEPT 310U>
8	8B-NFY-023-010		PANEL, FR HR<310LH, 310K, 310EZ>	33	87-A91-422-010		BUSHING, AC CORD (U) <310U>
9	8B-NFY-014-010		KNOB, RTRY JOG	34	8B-NF9-025-010		PANEL, RIGHT
10	8B-NFY-015-010		KNOB, RTRY VOL	35	8B-NFY-059-010		CABI, REAR EZSFD<310EZ>
11	8Z-NF6-210-010		DMPR, 150 N	35	8B-NFY-061-010		CABI, REAR EZSFD RDS<315EZ>
12	8B-NFY-022-010		CABI, FR EZ RDS<315EZ>	35	8B-NFY-058-010		CABI, REAR KSFSD<310K>
12	8B-NFY-019-010		CABI, FR LH<EXCEPT 315EZ, 310U>	35	8B-NFY-057-010		CABI, REAR LHSFD<310LH>
12	8B-NFY-001-010		CABI, FR U<310U>	35	8B-NFY-060-010		CABI, REAR LHSFD 510<510LH>
13	8B-NFY-012-010		KEY, FUN	35	8B-NFY-048-010		CABI, REAR USM<310U>
14	8B-NFY-036-010		REFLECTOR, ECO	36	88-906-251-110		FF-CABLE, 6P 1.25 (RVS-FACE)
15	8B-NFY-010-010		KEY, OPE 1W	37	8B-NF9-211-010		HLDR, TR S
16	8B-NFY-013-010		KEY, GEO	38	8B-NFY-018-010		KEY, RDS<315EZ>
17	8B-NF9-026-010		PANEL, LEFT	A	87-067-703-010		TAPPING SCREW, BVT2+3-10
18	8B-NF9-027-010		PANEL, TOP	B	87-NF4-224-010		S-SCREW, IT3B+3-8 CU
19	8B-NFY-201-010		GUIDE, FL 100-40 BNFY	C	87-078-200-010		S-SCREW, ITC+4-8 R
20	88-911-101-110		FF-CABLE, 11P 1.25	D	87-067-689-010		TAPPING SCREW, BVTT+3-8
21	88-908-301-110		FF-CABLE, 8P 1.25	E	87-723-096-410		QT2+3-10W/O SLOT BL
22	8A-NF8-206-010		HLDR, PWB M	F	87-721-097-410		QT2+3-12 GLD
23	87-NF4-216-010		HLDR, LOCK 1	G	87-067-641-010		UTT2+3-8 (W/O SLOT) BL
24	86-NF9-224-010		SPR-C, LOCK	H	87-721-096-410		QT2+3-10 GLD
25	82-NF5-229-010		PLATE, LOCK	I	87-067-584-010		BVT2+3-6 W/O SLOT<EXCEPT 510LH>

COLOR NAME TABLE

Basic color symbol	Color	Basic color symbol	Color	Basic color symbol	Color
B	Black	C	Cream	D	Orange
G	Green	H	Gray	L	Blue
LT	Transparent Blue	N	Gold	P	Pink
R	Red	S	Silver	ST	Titan Silver
T	Brown	V	Violet	W	White
WT	Transparent White	Y	Yellow	YT	Transparent Yellow
LM	Metallic Blue	LL	Light Blue	GT	Transparent Green
LD	Dark Blue	DT	Transparent Orange	GM	Metallic Green
YM	Metallic Yellow	DM	Metallic Orange	PT	Transparent Pink
LA	Aqua Blue	GL	Light Green	HT	Transparent Gray

TAPE MECHANISM EXPLODED VIEW 1 / 1

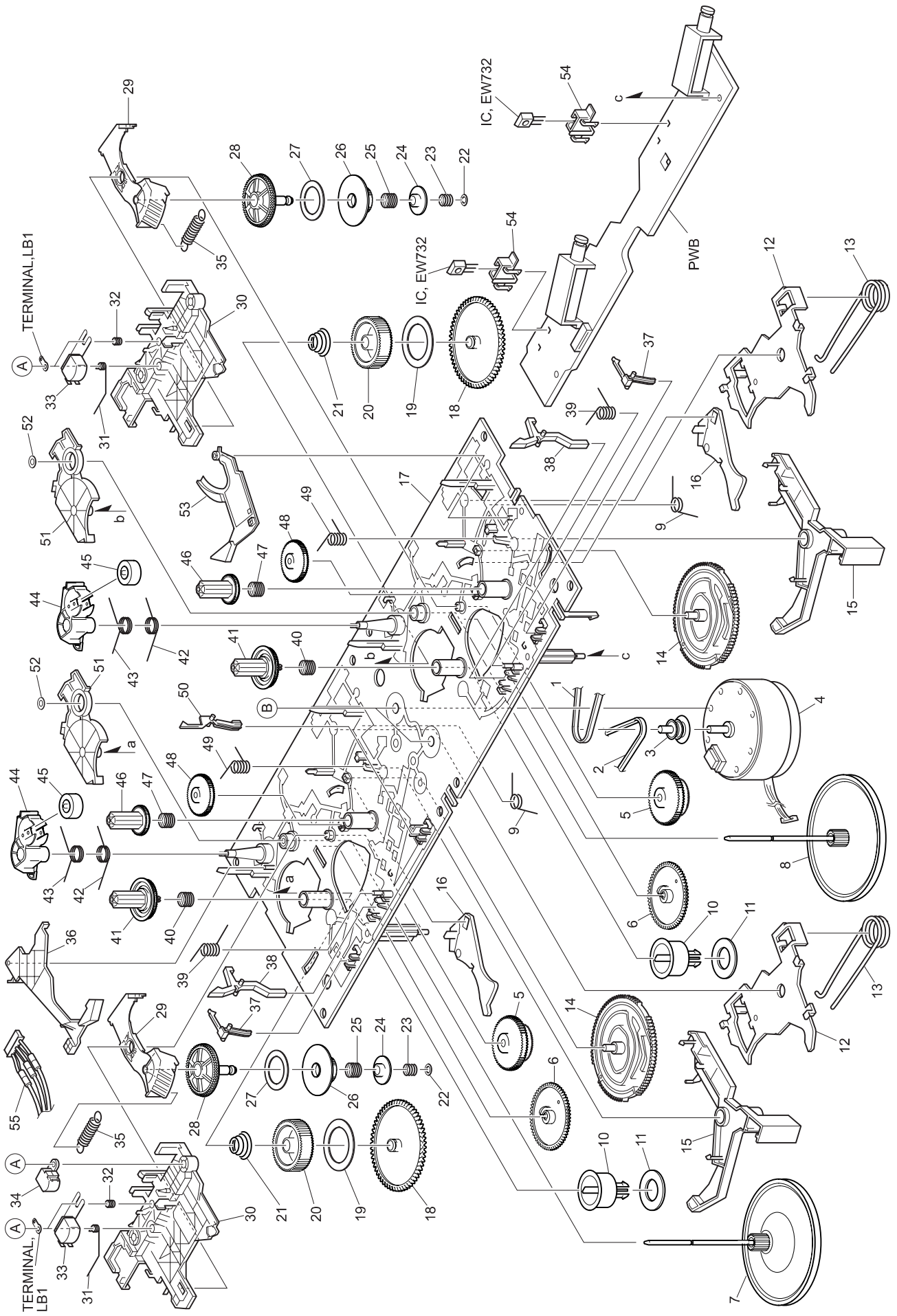

TAPE MECHANISM PARTS LIST 1 / 1

REF. NO.	PART NO.	KANRI NO.	DESCRIPTION	REF. NO.	PART NO.	KANRI NO.	DESCRIPTION
1	8Z-ZM3-227-010		BELT, MAIN M3	31	8Z-ZM3-233-010		SPR-T, BRG M3
2	8Z-ZM3-235-010		BELT, MAIN L	32	84-ZM2-227-310		SPR-C, AZIMUTH
3	8Z-ZM1-235-010		PULLEY, MOT	33	87-A90-403-110		HEAD, RPH MS15R
4	87-045-347-010		MOT, SHU2L 70	34	87-A90-404-010		HEAD, EH LE15B
5	8Z-ZM1-232-010		GEAR, IDL FF/REW	35	8Z-ZM3-239-010		SPR-E, FR
6	8Z-ZM3-244-010		GEAR, CAM TD20	36	8Z-ZM3-211-010		LEVER, EJECT R
7	8Z-ZM3-256-010		FLY-WHL ASSY, M3 R	37	8Z-ZM3-225-010		LEVER, STOP
8	8Z-ZM3-255-010		FLY-WHL ASSY, M3 L	38	8Z-ZM3-221-010		LEVER, CAS
9	8Z-ZM3-231-010		SPR-T, TRIG	39	8Z-ZM3-234-010		SPR-T, LVR CAS
10	8Z-ZM3-213-010		CLR, MG	40	8Z-ZM3-223-010		SPR-C, REEL R M3
11	8Z-ZM3-616-010		RING MAGNET 4	41	8Z-ZM1-225-110		GEAR, REEL R
12	8Z-ZM3-243-010		LEVER ASSY, HD UP	42	8Z-ZM3-240-010		SPR-T, T-UP M3
13	8Z-ZM3-238-010		SPR-T, HD UP	43	8Z-ZM3-237-010		SPR-T, PINCH M3
14	8Z-ZM3-219-010		GEAR, CAM M3	44	8Z-ZM3-215-010		LEVER, PINCH M3
15	8Z-ZM3-206-010		LEVER, TRIG	45	8Z-ZM1-261-110		ROLLER ASSY, PINCH
16	8Z-ZM3-209-010		LEVER, CAM FR	46	8Z-ZM1-226-010		GEAR, REEL L
17	8Z-ZM3-203-010		CHAS ASSY, M3	47	8Z-ZM3-222-010		SPR-C, REEL L M3
18	8Z-ZM1-228-010		GEAR, SLIP T-UP B	48	8Z-ZM3-251-010		GEAR, IDL REW M3
19	8Z-ZM1-265-010		FELT, T-UP	49	8Z-ZM3-236-010		SPR-T, PLAY M3
20	8Z-ZM1-227-010		GEAR, SLIP T-UP A	50	8Z-ZM1-240-110		LVR, REC(*)
21	8Z-ZM1-251-110		SPR-C, T-UP SLIP	51	8Z-ZM3-216-010		LEVER, T-UP M3
22	8Z-ZM1-275-010		W-L, 1, 47-4-0.25	52	87-B10-301-010		W-L, 1.63-3.2-05 SLIT
23	8Z-ZM1-257-010		SPR-C, F/R	53	8Z-ZM3-212-010		LEVER, EJECT L
24	8Z-ZM1-236-010		CLR, SLIP FF/REW	54	8Z-ZM3-214-010		HLDR, IC
25	8Z-ZM3-226-010		SPR-C, FR M3	55	86-ZM3-605-110		CONN ASSY, 8P -RFB
26	8Z-ZM3-250-010		GEAR, SLIP F/R A M3	A	84-ZM2-242-010		S-SCREW, AZ1-2-6.4
27	8Z-ZM1-269-010		FELT, FF/REW 2	B	8Z-ZM2-220-110		V+2.6 ZZM-2
28	8Z-ZM1-238-110		GEAR, SLIP FF/REW B 2				
29	8Z-ZM3-220-010		LEVER, FR M3				
30	8Z-ZM3-205-010		LEVER, PLAY M3				

GENERAL SPEAKER DISASSEMBLY INSTRUCTIONS (FOR REFERENCE)

Type.1

Insert a flat-bladed screwdriver into the position indicated by the arrows and remove the panel. Remove the screws of each speaker unit and then remove the speaker units.

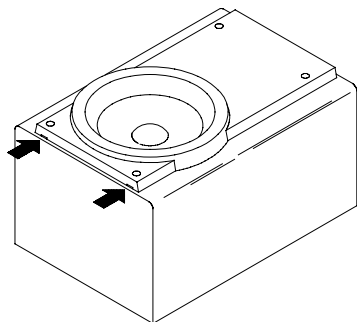

Type.2

Remove the grill frame and four pieces of rubber caps by pulling out with a flat-bladed screwdriver. Remove the screws from hole where installed rubber caps. Insert a flat-bladed screwdriver into the position indicated by the arrows and remove the panel. Remove the screws of each speaker unit and then remove the speaker units.

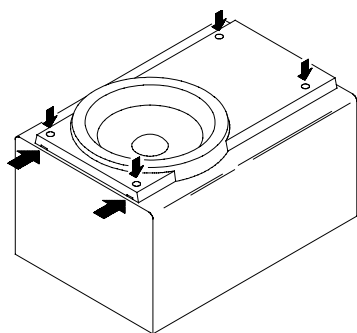

Type.3

Insert a flat-bladed screwdriver into the position indicated by the arrows and remove the panel. Turn the speaker unit to counter-clockwise direction while inserting a flat-bladed screwdriver into one of the hollows around speaker unit, and then remove the speaker unit. After replacing the speaker unit, install it turning to clockwise direction until "click" sound comes out.

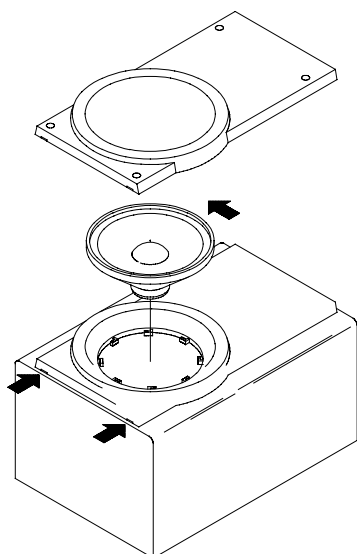

Type.4

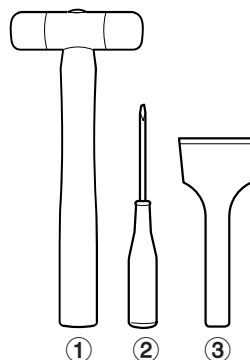

TOOLS

- ① Plastic head hammer
- ② (⊖) flat head screwdriver
- ③ Cut chisel

How to Remove the PANEL, FR

1. Insert the (⊖) flat head screwdriver tip into the gap between the PANEL, FR and the PANEL, SPKR. Tap the head of the (⊖) flat head screwdriver with the plastic hammer head, and create the clearance as shown in Fig-1.
2. Insert the cut chisel in the clearance, and tap the head of the cut chisel with plastic hammer as shown in Fig-2, to remove the PANEL, FR.
3. Place the speaker horizontally. Tap head of the cut chisel with plastic hammer as shown in Fig-3, and remove the PANEL, FR completely.

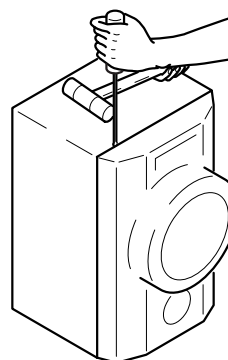

Fig-1

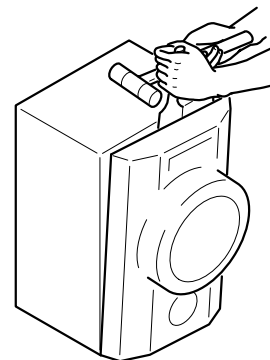

Fig-2

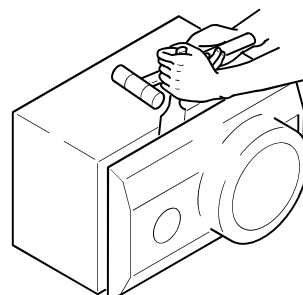

Fig-3

How to Attach the PANEL, FR

Attach the PANEL, FR to the PANEL, SPKR. Tap the four corners of the PANEL, FR with the plastic hammer to fit the PANEL, FR into the PANEL, SPKR completely.

SPEAKER PARTS LIST <SX-NAJ312 (YUS1N, YUSN) / SX-NSZ312 (YLSC, YSC)>

REF. NO.	PART NO.	KANRI NO.	DESCRIPTION
1	8B-NSY-001-010		PANEL, FR
2	8B-NSY-003-010		PANEL, TW
3	8B-NSY-009-010		PROTECTOR, TW
4	8B-NSY-010-010		SPKR, CERAMIC ASSY
5	8B-NSY-005-010		GRILLE, FRAME ASSY
6	8B-NSY-602-010		SPKR, W 140/30<YLSC, YUS1N, YUSN>
6	8B-NSY-604-010		SPKR, W 140/25<YSC>
7	8B-NSK-604-010		SPKR, T 60<YLSC, YUS1N, YUSN>
7	8B-NSY-606-010		SPKR, TW 60L<YSC>
8	8B-NSY-610-010		CORD, SPKR

SPEAKER PARTS LIST <SX-NSZ702 (YLSC)>

REF. NO.	PART NO.	KANRI NO.	DESCRIPTION
1	8B-NSJ-001-010		PANEL, FR
2	8B-NSJ-003-010		PANEL, DUCT
3	8B-NSJ-004-010		PROTECTOR
4	8A-NSJ-006-010		BADGE, AIWA S35
5	8B-NSJ-606-010		SPKR, W 160 35/4
6	8B-NSJ-604-010		SPKR, TW 60
7	8B-NSJ-612-010		CORD, SPKR

ACCESSORIES / PACKAGE LIST

REF. NO.	PART NO.	KANRI NO.	DESCRIPTION
1	8B-NFY-913-010		IB, U (ESF) M<310U>
1	8B-NFY-922-010		IB, LH (ESP) IN<310LH, 510LH>
1	8B-NFY-925-010		IB, K (E) IN<310K>
1	8B-NFY-936-010		IB, EZ (9L) IN-SZ315 (RDS) <315EZ>
1	8B-NFY-937-010		IB, EZ (9L) IN<310EZ>
2	87-A90-118-010		ANT, WIRE FM (Z) <310K, 310EZ, 315EZ>
2	87-043-115-010		FEEDER-ANT, FM<310U, 310LH, 510LH>
3	87-A92-150-010		ANT, LOOP AM NO-CONT
4	8Z-NFY-702-010		RC UNIT, ZAS02
△	87-A91-017-010		PLUG, CONVERSION JT-0476<310LH, 510LH>
△	87-099-811-010		PLUG, ADPTR CONV (K) <310K>