

DW-0138-001

131018

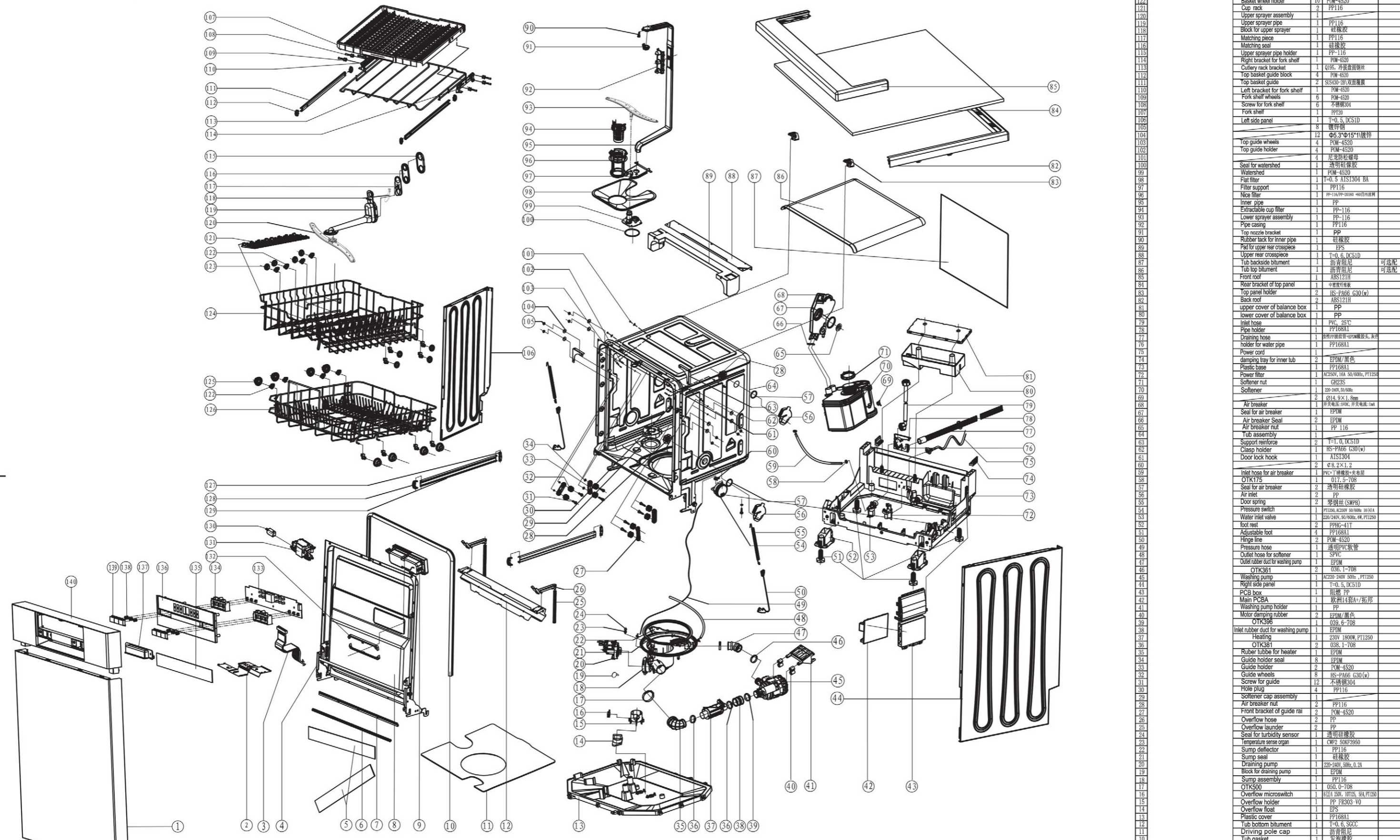

数量	代号	名称	数量	材料	备注
1	Q195镀锌板	Lower basket	1	Q195镀锌板	
8	HS-PA66 G30(w)	Wheels of lower basket	8	HS-PA66 G30(w)	
1	Q195镀锌板	Upper basket	1	Q195镀锌板	
8	HS-PA66 G30(w)	Wheels of upper basket	8	HS-PA66 G30(w)	
18	POM-4520	Basket wheel holder	18	POM-4520	
2	PP116	Cup rack	2	PP116	
1	PP116	Upper sprayer assembly	1	PP116	
1	PP116	Upper sprayer pipe	1	PP116	
1	硅胶板	Block for upper sprayer	1	硅胶板	
1	PP116	Matching piece	1	PP116	
1	硅胶板	Matching seal	1	硅胶板	
1	PP-116	Upper sprayer pipe holder	1	PP-116	
1	POM-4520	Right bracket for fork shelf	1	POM-4520	
1	Q195 冲裁折弯钢板	Cutlery rack bracket	1	Q195 冲裁折弯钢板	
4	POM-4520	Top basket guide block	4	POM-4520	
2	SUS304-2B 双面薄板	Top basket guide	2	SUS304-2B 双面薄板	
1	POM-4520	Left bracket for fork shelf	1	POM-4520	
6	POM-4520	Fork shelf wheels	6	POM-4520	
6	不锈钢304	Screw for fork shelf	6	不锈钢304	
1	PP116	Fork shelf	1	PP116	
8	T=0.5, DC51D	Left side panel	8	T=0.5, DC51D	
12	Φ6.3*Φ15*1不锈钢	Top guide wheels	12	Φ6.3*Φ15*1不锈钢	
4	POM-4520	Top guide holder	4	POM-4520	
4	尼龙防松螺母	Seal for watershed	4	尼龙防松螺母	
1	透明硅胶板	Watershed	1	透明硅胶板	
1	POM-4520	Flat filter	1	POM-4520	
1	T=0.5 AISI304 BA	Filter support	1	T=0.5 AISI304 BA	
1	PP116	Nice filter	1	PP116	
1	PP-116/PP-2016 0.01/0.01/0.01	Inner pipe	1	PP-116/PP-2016 0.01/0.01/0.01	
1	PP	Extricable cup filter	1	PP	
1	PP-116	Lower sprayer assembly	1	PP-116	
1	PP116	Pipe casing	1	PP116	
1	PP	Top nozzle bracket	1	PP	
1	硅胶板	Rubber tack for inner pipe	1	硅胶板	
1	EPS	Pad for upper rear crosspiece	1	EPS	
1	T=0.6, DC51D	Upper rear crosspiece	1	T=0.6, DC51D	
1	海青阻尼	Tube backside bitument	1	海青阻尼	可适配
1	海青阻尼	Tube top bitument	1	海青阻尼	可适配
1	ABS121H	Front roof	1	ABS121H	
1	中密度纤维板	Rear bracket of top panel	1	中密度纤维板	
2	HS-PA66 G30(w)	Top panel holder	2	HS-PA66 G30(w)	
1	ABS121H	Back roof	1	ABS121H	
1	PP	Upper cover of balance box	1	PP	
1	PVC-25°C	Lower cover of balance box	1	PVC-25°C	
1	PP168A1	Inlet hose	1	PP168A1	
1	PP	Pipe holder	1	PP	
1	塑料冲裁板+凸出端+凸出端+凸出端	Draining hose	1	塑料冲裁板+凸出端+凸出端+凸出端	
1	PP168A1	Holder for water pipe	1	PP168A1	
1	EPDM/黑色	Power cord	1	EPDM/黑色	
2	EPDM/黑色	Damping tray for inner tub	2	EPDM/黑色	
1	PP168A1	Plastic base	1	PP168A1	
1	AC250V, 16A 50/60Hz, PT1250	Power filter	1	AC250V, 16A 50/60Hz, PT1250	
1	GH23S	Softener nut	1	GH23S	
1	220-240V, 50/60Hz	Softener	1	220-240V, 50/60Hz	
2	Φ14, 9×1, 8mm	Air breaker	2	Φ14, 9×1, 8mm	
1	PPM	Seal for air breaker	1	PPM	
2	EPDM	Air breaker seal	2	EPDM	
1	PP-116	Air breaker nut	1	PP-116	
1	PP	Tube assembly	1	PP	
2	T=1.0, DC51D	Support reinforce	2	T=1.0, DC51D	
1	HS-PA66 G30(w)	Clasp holder	1	HS-PA66 G30(w)	
1	AISI304	Door lock hook	1	AISI304	
2	Φ8, 2×1.2	Inlet hose for air breaker	2	Φ8, 2×1.2	
1	PVC-丁腈橡胶+夹布层	OTK175	1	PVC-丁腈橡胶+夹布层	
1	OTK175	Seal for air breaker	1	OTK175	
2	透明硅胶板	Air inlet	2	透明硅胶板	
2	PP	Door spring	2	PP	
2	琴钢丝 (SWP6)	Pressure switch	2	琴钢丝 (SWP6)	
1	PT1250, AC250V 50/60Hz 16/16A	Water inlet valve	1	PT1250, AC250V 50/60Hz 16/16A	
1	220/240V, 50/60Hz, 0.8, PT1250	Foot rest	1	220/240V, 50/60Hz, 0.8, PT1250	
2	PPHC-41T	Adjustable foot	2	PPHC-41T	
1	PP168A1	Hinge line	1	PP168A1	
2	POM-4520	Pressure hose	2	POM-4520	
1	透明PVC软管	Outlet hose for softener	1	透明PVC软管	
1	SPVC	Outlet rubber duct for washing pump	1	SPVC	
1	EPDM	OTK361	1	EPDM	
2	Φ8, 1-708	Washing pump	2	Φ8, 1-708	
1	AC220-240V 50/60Hz, PT1250	Right side panel	1	AC220-240V 50/60Hz, PT1250	
1	T=0.5, DC51D	PCB box	1	T=0.5, DC51D	
1	阻燃 PP	Main PCB	1	阻燃 PP	
1	欧洲14线A7/拓邦	Washing pump holder	1	欧洲14线A7/拓邦	
1	PP	Motor damping rubber	1	PP	
2	EPDM/黑色	OTK308	2	EPDM/黑色	
1	038, 6-708	Inlet rubber duct for washing pump	1	038, 6-708	
1	038, 1-708	Heating	1	038, 1-708	
2	220V 1800W PT1250	OTK381	2	220V 1800W PT1250	
1	EPDM	Rubber tube for heater	1	EPDM	
8	EPDM	Guide holder seal	8	EPDM	
2	POM-4520	Guide holder	2	POM-4520	
8	HS-PA66 G30(w)	Guide wheels	8	HS-PA66 G30(w)	
12	不锈钢304	Screw for guide	12	不锈钢304	
4	PP116	Hole plug	4	PP116	
1	PP116	Softener cap assembly	1	PP116	
1	PP116	Air breaker nut	1	PP116	
2	POM-4520	Front bracket of guide rail	2	POM-4520	
2	PP	Overflow hose	2	PP	
2	PP	Overflow launder	2	PP	
1	透明硅胶板	Seal for turbidity sensor	1	透明硅胶板	
1	OWP2 50K/3950	Temperature sense organ	1	OWP2 50K/3950	
1	PP116	Sump deflector	1	PP116	
1	硅胶板	Sump seal	1	硅胶板	
1	220-240V, 50Hz, 0.2A	Draining pump	1	220-240V, 50Hz, 0.2A	
1	EPDM	Block for draining pump	1	EPDM	
1	PP116	Sump assembly	1	PP116	
1	050, 0-708	OTK500	1	050, 0-708	
1	6124 15W, 10V15, SEA, PT1250	Overflow microswitch	1	6124 15W, 10V15, SEA, PT1250	
1	PP-FRC03-Y0	Overflow holder	1	PP-FRC03-Y0	
1	EPS	Overflow float	1	EPS	
1	PP168A1	Plastic cover	1	PP168A1	
1	T=0.6, SG0C	Tube bottom bitument	1	T=0.6, SG0C	
1	海青阻尼	Driving pole cap	1	海青阻尼	
1	发泡橡胶	Tub gasket	1	发泡橡胶	
1	110V/220V, 50/60Hz, 灰色	Detergent dispenser	1	110V/220V, 50/60Hz, 灰色	
1	T=0.4mm SUS304 BA	Inner door	1	T=0.4mm SUS304 BA	
1	硅胶板	Lower seal of inner door	1	硅胶板	
1	PP116	Lower seal holder	1	PP116	
2	海青阻尼	Inner door upper bitument	2	海青阻尼	可适配
1	PP-346	Left-Right hinge	1	PP-346	
1	PP-346	Casing for wiring	1	PP-346	
1	T=0.6, DC52D	External door	1	T=0.6, DC52D	

序号	代号	名称	数量	材料	备注
143	PP116	Salt funnel	1	PP116	
1	PP116	Draining hose hanger	1	PP116	
1	ABS 121H	Baseboard	1	ABS 121H	
1	ABS 121H	Control panel	1	ABS 121H	
6	ABS 121H	Power button	6	ABS 121H	
6	不锈钢304本色	Spring	6	不锈钢304本色	
1	ABS 121H	Plastic handle	1	ABS 121H	
1	ABS 121H	Control board holder	1	ABS 121H	
1	PCV-L1.5	Control panel plastic ornament	1	PCV-L1.5	
2	ABS 121H	Button	2	ABS 121H	
1	自粘, L=1.7M	Display PCB	1	自粘, L=1.7M	
2	T=1.2, DC51D	Dispenser holder	2	T=1.2, DC51D	
1	PP116	Door lock assembly	1	PP116	
1	16A 250VAC, T105, 50Hz, PT1250	Microswitch	1	16A 250VAC, T105, 50Hz, PT1250	
2	T=1.0 AISI430 2B	Upper basket guide	2	T=1.0 AISI430 2B	
2	POM-4520	Basket guide front block	2	POM-4520	
2	PP116	Basket guide rear block	2	PP116	

总装图 DW-0138-001
 型号: W60B1A401L-AB1
 图样比例: 1:1
 出图日期: 2010.11.10
 设计: 李金波
 审核: 李金波
 批准: 李金波
 共1页 第1页
 材料: 中山格兰仕日用电器有限公司
 Galanz

借(通)用件登记
 旧底图总号
 底图总号
 出图审查
 日期