

Réfrigérateur

GCG23YESBFWW

(Partie 1)

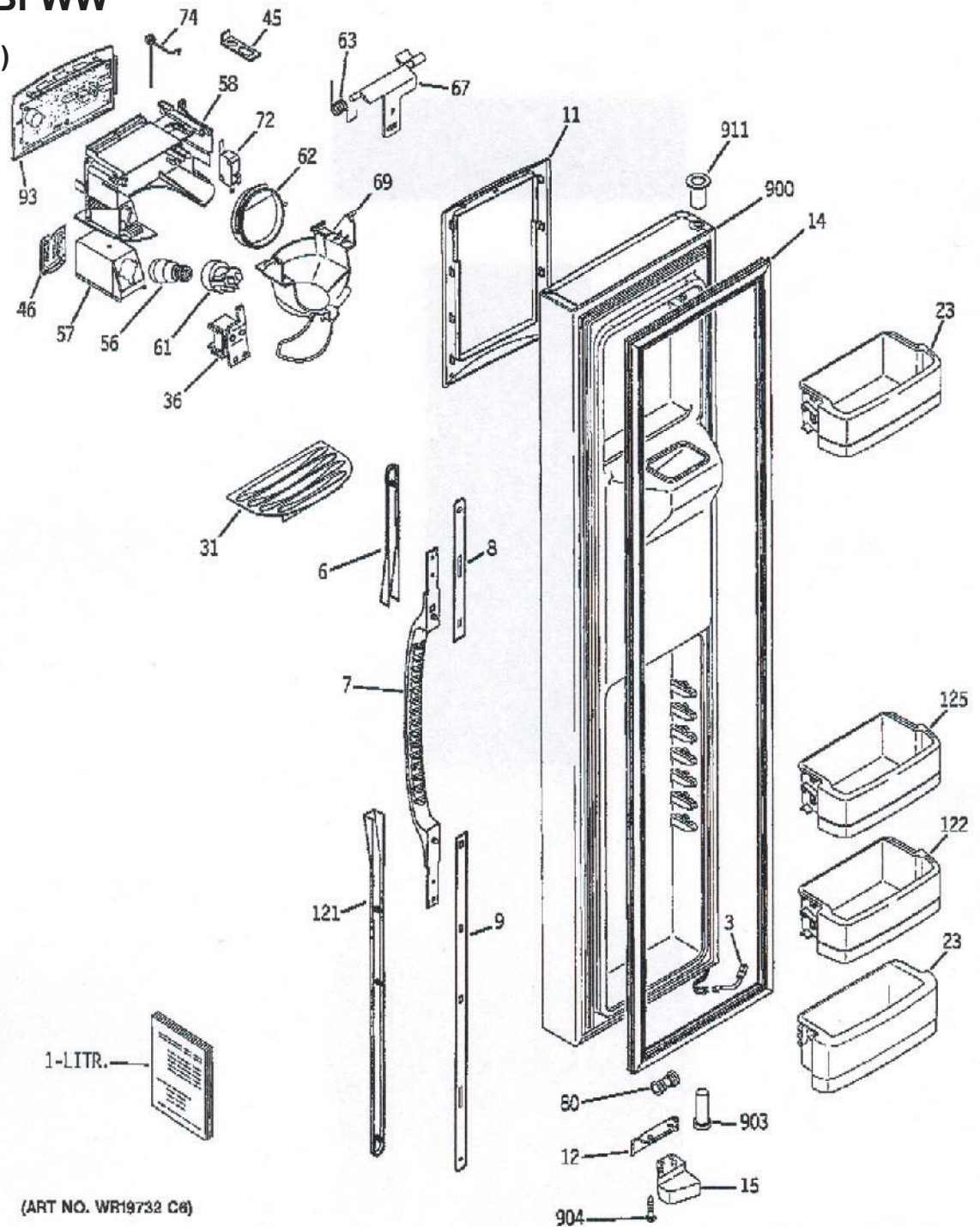

(ART NO. WR19732 Cg)

3	WR09X10132	HARNESS JUMPER DOOR	63	WR02X10585	SPRING RECESS DOOR
6	WR12X10152	TAIL HANDLE SXS WH	67	WR17X10706	CRANK DOOR RECESS
7	WR12X10782	HANDLE SXS ASM	69	WR17X11864	ICE ASSEMBLY
8	WR12X10150	TRIM HANDLE SXS	72	WR23X10224	SWITCH
9	WR12X10190	TRIM HANDLE SXS	74	WR02X10584	SPRING FUNNEL
11	WR38X10227	RECESS TRIM CLAD MDEL WH	80	WR02X11330	UNION CONNECTOR
12	WR02X10649	STOP DOOR WH	93	WR55X10483	INTERFACE DISP ASM
14	WR24X10156	GASKET DOOR FZ WH	121	WR12X10193	TAIL HANDLE SXS WH
15	WR02X10638	CAM CLOSURE FZ WH	122	WR71X10291	MODULE SHELF FZ
23	WR71X10355	MODULE SHELF FZ FIXED	125	WR71X10379	MODULE SFELF FZ
31	WR17X11654	GRILLE RECESS WH	900	WR78X11514	DOOR ASM FZ KIT WH
36	WR62X10055	SOLENOID ASM	903	WR01X10208	THIMBLE DOOR DTM FZ WH
56	WR02X10675	BULB RECS 12V	904	WR01X10611	SCREW DOOR STOP
58	WR17X12117	HOUSING SHIELD DISP	904	WR01X10611	SCREW DOOR STOP T20
62	WR17X11653	DOOR RECESS ASM	911	WR01X10207	THIMBLE DOOR TOP WH

Réfrigérateur

GCG23YESBFWW

(Partie 2)

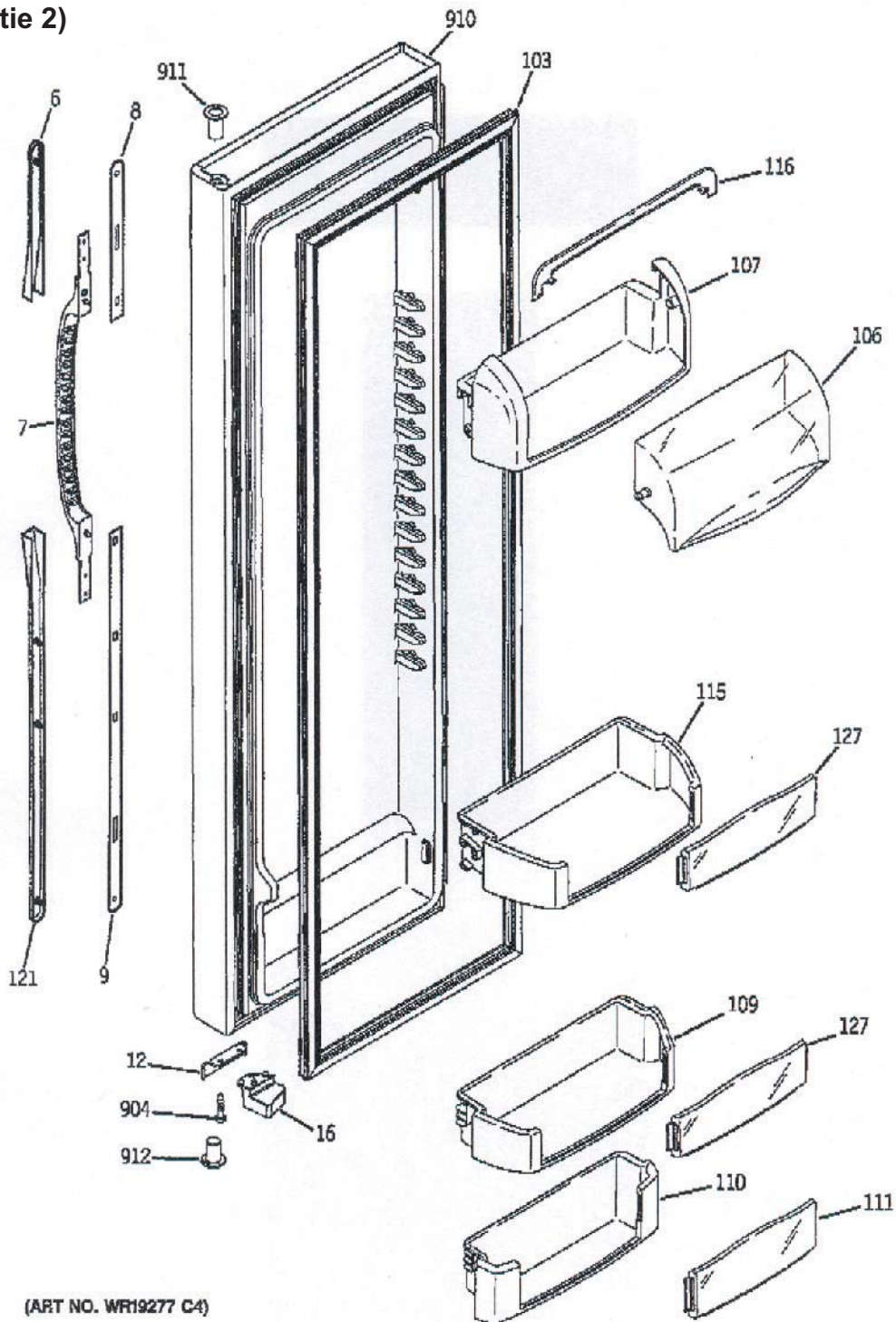

(ART NO. WR19277 C4)

6	WR12X10152	TAIL HANDLE SXS WH	111	WR71X10579	INSERT MODULE FF FIXED
7	WR12X10782	HANDLE SXS ASM	115	WR71X10607	MODULE SHELF FF
8	WR12X10150	TRIM HANDLE SXS	116	WR22X10043	TRIM DAIRY COMPARTMENT
9	WR12X10190	TRIM HANDLE SXS	121	WR12X10193	TAIL HANDLE SXS WH
12	WR02X10649	STOP DOOR WH	127	WR71X10289	INSERT MODULE
16	WR02X10637	CAM CLOSURE FF WH	904	WR01X10611	SCREW DOOR STOP
103	WR24X10155	GASKET DOOR FF WH	904	WR01X10611	SCREW DOOR STOP T20
106	WR22X10042	DOOR DAIRY CLEAR	910	WR78X11771	DOOR FOAM ASM
107	WR22X10041	COMPARTMENT DAIRY	911	WR01X10207	THIMBLE DOOR TOP WH
109	WR71X10605	MODULE SHELF FF	912	WR01X10206	THIMBLE DOOR BTM WH
110	WR71X10297	MODULE SHELF FIXED FF			

Réfrigérateur

GCG23YESBFWW

(Partie 3)

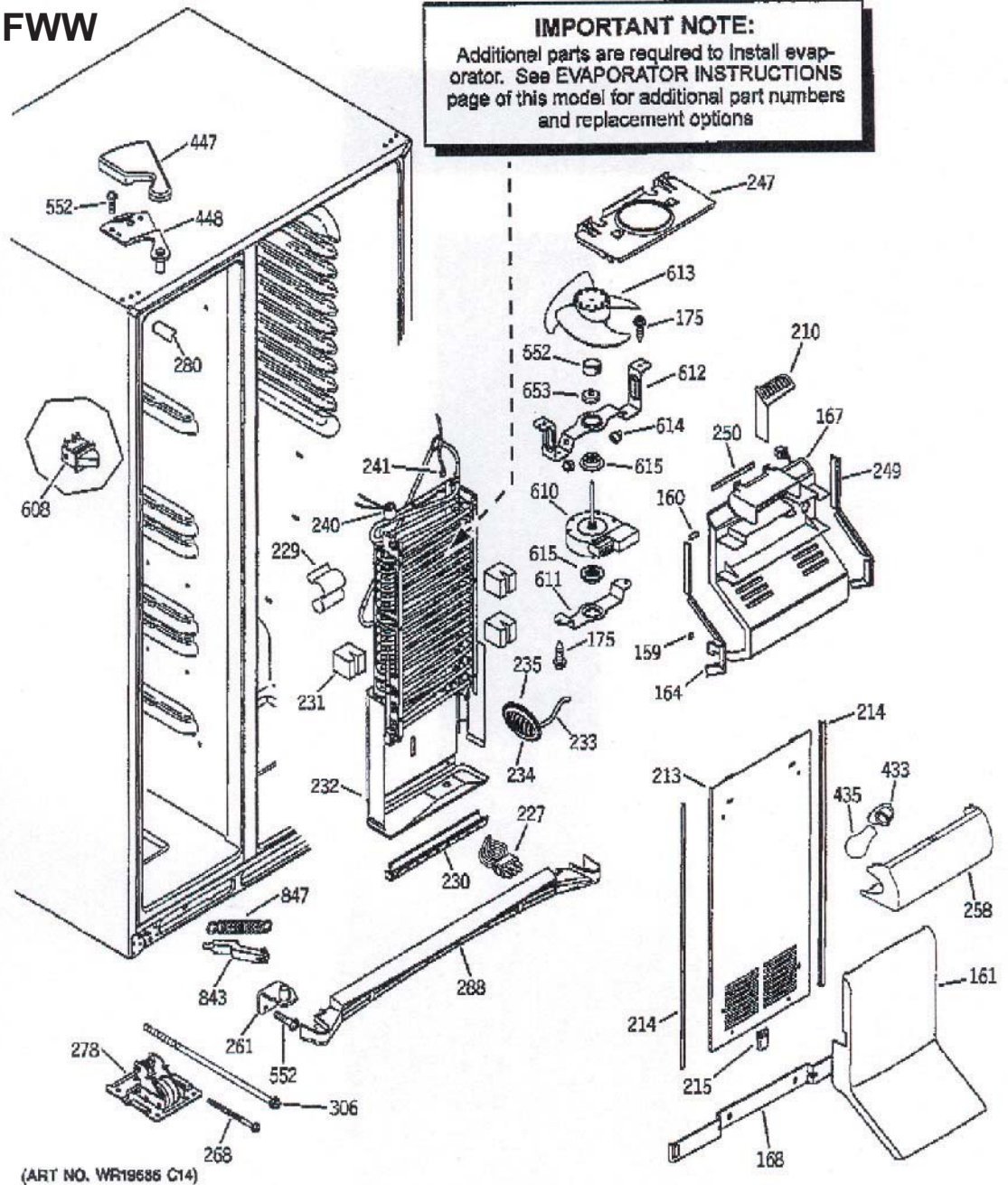

(ART NO. WR19586 C14)

159	WR14X10067	FOAM STRIP SE ADH	249	WR14X10165	GASKET PLENUM
160	WR14X10068	FOAM STRIP SE ADH	250	WR14X10069	FOAM STRIP SE ADH
161	WR17X10817	TOWER AIR FZ LOWER	258	WR17X11480	SHIELD LIGHT FZ
164	WR14X10164	GASKET PLENUM	261	WR13X10137	HINGE BTM & PIN ASM WH
167	WR17X11477	PLENUM FAN EVAPORATOR	268	WR01X10210	SCREW MOBILITY 3.5
168	WR02X10674	BRACKET FZ TOWER LOWER	278	WR02X12274	MOBILITY FRONT ASM
175	WR02X10035	SCR 8618 AB IHM 5/8 S	280	WR02X10640	CAP CORNER OC WH
210	WR74X10131	GUARD WIRING	288	WR71X10194	GRILLE BASE WH
213	WR17X11671	COVER EVAPORATOR FRONT	306	WR02X12271	SCREW MOBILITY 23
214	WR14X10153	GASKET EVAP COVER	447	WR02X10657	COVER HINGE FZ WH
215	WR01X10211	BRACKET FZ TOWER UPPER	448	WR13X10214	HINGE TOP & PIN ASM FZ
227	WR23X10337	HARNES AC FZ INTERMEDIA	608	WR23X10161	SWITCH LIGHT
229	WR02X10552	CLIP EVAP THERMISTOR	610	WR60X10185	MOTOR DC EVAP FAN ASM
230	WR51X10042	HEATER & BRACKET ASM	611	WR02X10764	BRACKET EVAP FAN BTM
231	WR02X10669	BLOCK EVAP SEAL	612	WR02X10653	BRACKET ORIFICE FAN
232	WR17X10811	SHIELD ASM TROUGH	613	WR60X10208	BLADE EVAP FAN ASM
233	WR55X10025	SENSOR TEMP FZ	614	WR02X10540	BUMPER LID
234	WR02X10647	GRILLE SENSOR	615	WR02X12008	GROMMET EVAP FAN
235	WR02X10668	SHUNT SENSOR	652	WR02X12149	RING COMPRESSION
240	WR50X10068	DEFROST THERMOSTAT	653	WR02X10322	CAP DUST
241	WR55X10025	SENSOR TEMPERATURE FF	843	WR11X10008	LEVER ASM FZ SIDE WH
247	WR17X10812	ORIFICE FAN ASM			

Réfrigérateur

GCG23YESBFWW

(Partie 4)

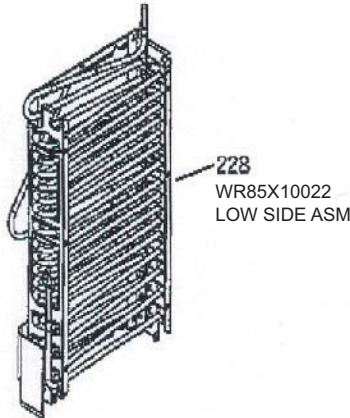

There are two approved evaporator replacement methods. The Lokring® method requires no brazing, by utilizing tight mechanical connections. The heat shield uses the traditional brazing method, but provides protection to the upper liner while brazing the evaporator connections in the freezer compartment.

Always add a new filter drier when servicing the sealed system. Follow each step of the instructions included with the replacement evaporator.

LOKRING® METHOD

LokRing® is a method of installing the evaporator in the freezer without the use of a torch. It utilizes a mechanical connection rather than a brazed connection. Apply a few drops of LokPrep (a special cleaning and sealing solution), to the ends of the tubing that you wish to join together. The LokRing® tool compresses the connector to ensure a tight mechanical connection. The parts shown to the right are required for the LokRing® replacement method.

For additional information on how to use LokRing®, call 1-800-848-7722 & order publication # 31-9067 (LokRing repair procedures manual) and publication # 31-9066 (Lokring repair procedures VHS video tape).

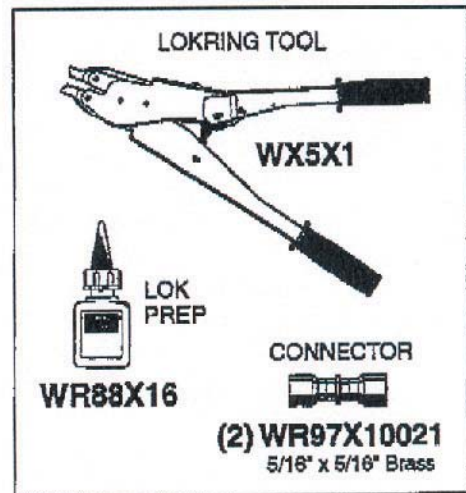

HEAT SHIELD METHOD

The heat shield kit is used to prevent damage to the refrigerator liner when brazing the evaporator into the sealed system. Refer to the instructions included in the heat shield kit. The kit comes with enough heat absorbing paste, solder and tape to complete four repairs.

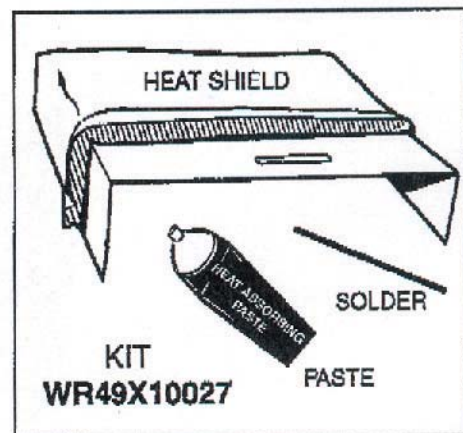

Réfrigérateur

GCG23YESBFWW

(Partie 5)

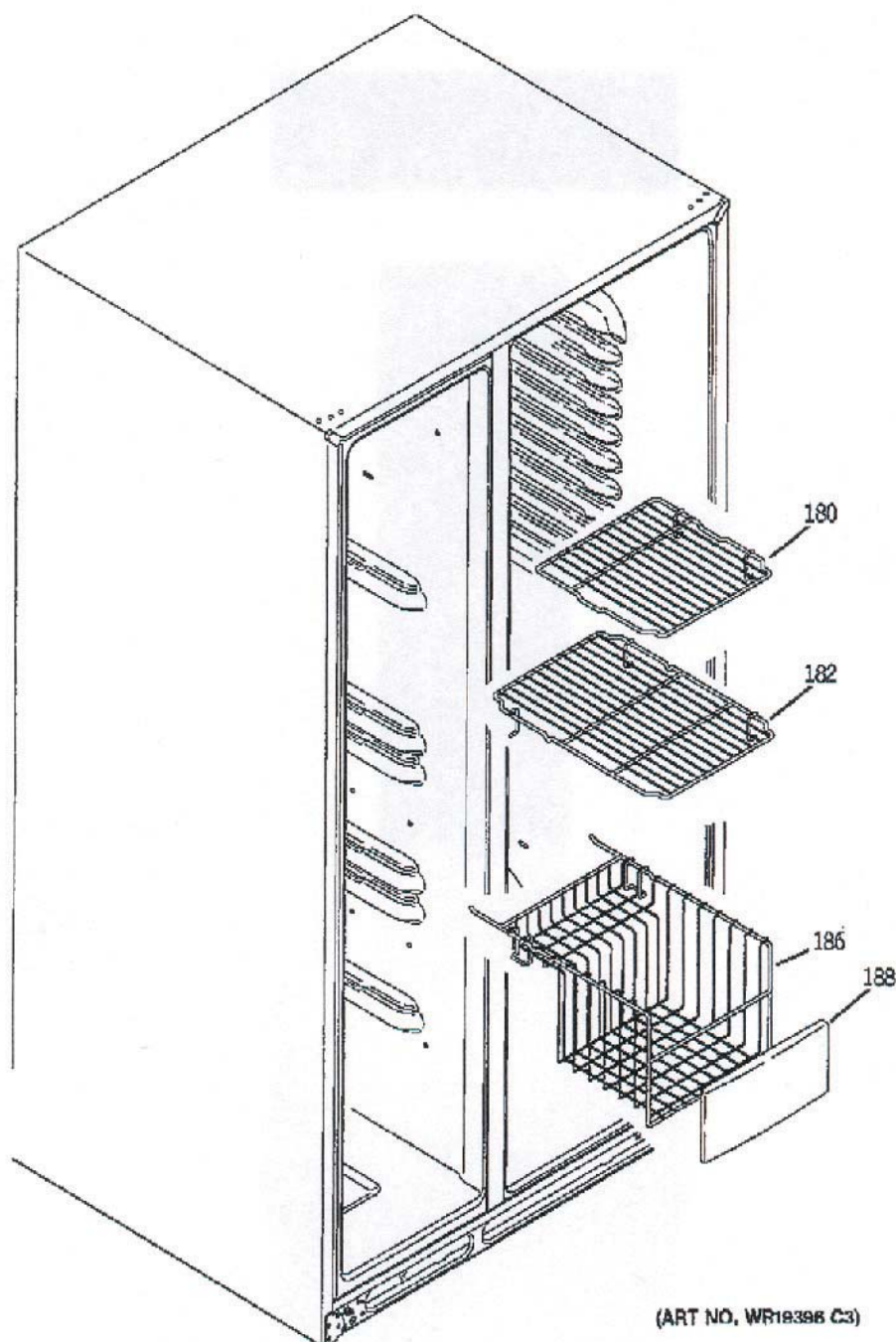

(ART NO. WR19396 C3)

180	WR71X10527	SHELF FIXED FZ
182	WR71X10292	SHELF SLIDEOUT FZ
186	WR21X10063	BASKET WIRE FZ
188	WR12X10682	HANDLE BASKET

Réfrigérateur

GCG23YESBFWW

(Partie 6)

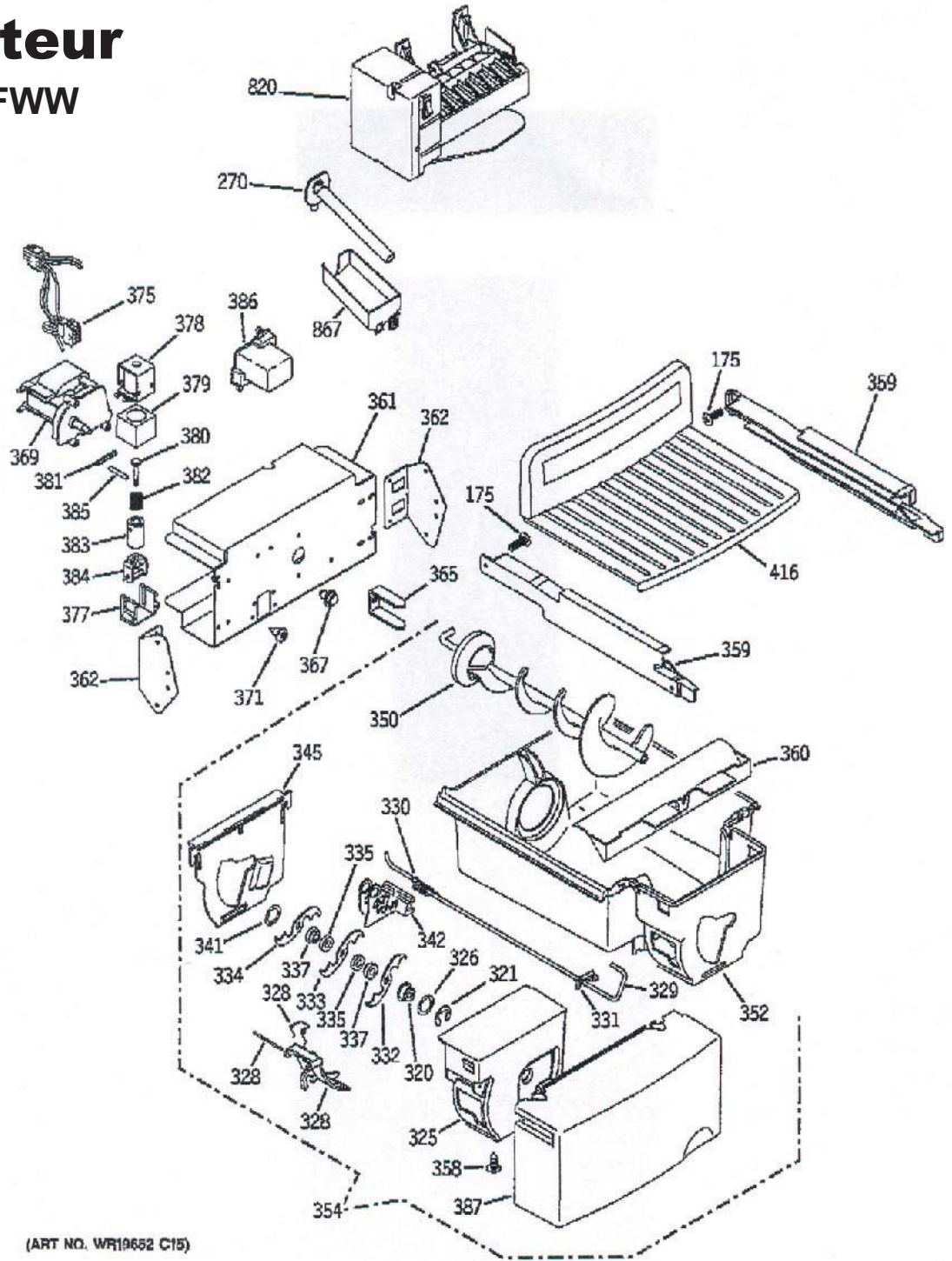

(ART NO. WR19652 C15)

175	WR01X10035	SCR 8-18 AB IHW 5/8 S	359	WR72X10145	GLIDE BKT RH
270	WR17X11506	GROMMET AND TUBE ASM	360	WR17X11449	DIVERTER OVERFLOW
320	WR01X10315	NUT AUGER FRT DISP	361	WR17X11614	COVER MOTOR & SOLENOID
321	WR1X1367D	RETAINER RINGE	362	WR02X11546	BRACKET ANGLE
325	WR17X11505	HOUSING CRUSHER DISP	365	WR02X11941	DRIVE AUGER DISP
326	WR1X1366D	WASHER	367	WR01X10618	SCR 8-18 TPT 1/4
328	WR17X10703	DEFLECTOR ICE DISP	369	WR60X10193	MOTOR CRUSHER DISP
329	WR17X10931	WIRE ACTUATOR DISP	371	WR01X10619	SCR 10-18 HI/LO HXW 1/2
330	WR02X10583	SPRING DEFLECTOR	375	WR23X10330	HARNES MOTOR & SOL
331	WR02X10580	RETAINER SPRING	378	WR62X10024	SOLENOID & ARM ASM
332	WR17X11239	BLADES MOVING DISP	379	WR17X1063	SHROUD SOLENOID
333	WR17X11240	BLADES MOVING DISP	380	WR17X1064	PLUNGER SOLENOID
334	WR17X11241	BLADES MOVING DISP	383	WR17X1065	COLLAR SOLENOID DISP
341	WR29X10045	WASHER CRUSHER BLADE	384	WR17X1066	STIRRUP SOLENOID DISP
342	WR02X10691	STATIONARY BLADES ASM	386	WR02X11767	BOOT AUGER MOTOR INT
345	WR17X11497	COVER CRUSHER HSG DISP	387	WR17X11087	COVER BUCKET DISP
350	WR17X11263	AUGER ASM DISP	416	WR71X10639	SHELF CHILLER
352	WR30X10055	BUCKET ICE DISP	820	WR30X10081	ICEMAKER ASM
354	WR17X11461	BUCKET AND AUGER ASM	867	WR29X10064	CUP FILL IM
358	WR01X10389	SCR 8-18 AB PHR 1/2 S			
359	WR72X10144	GLIDE BKT LH			

Réfrigérateur

GCG23YESBFWW

(Partie 7)

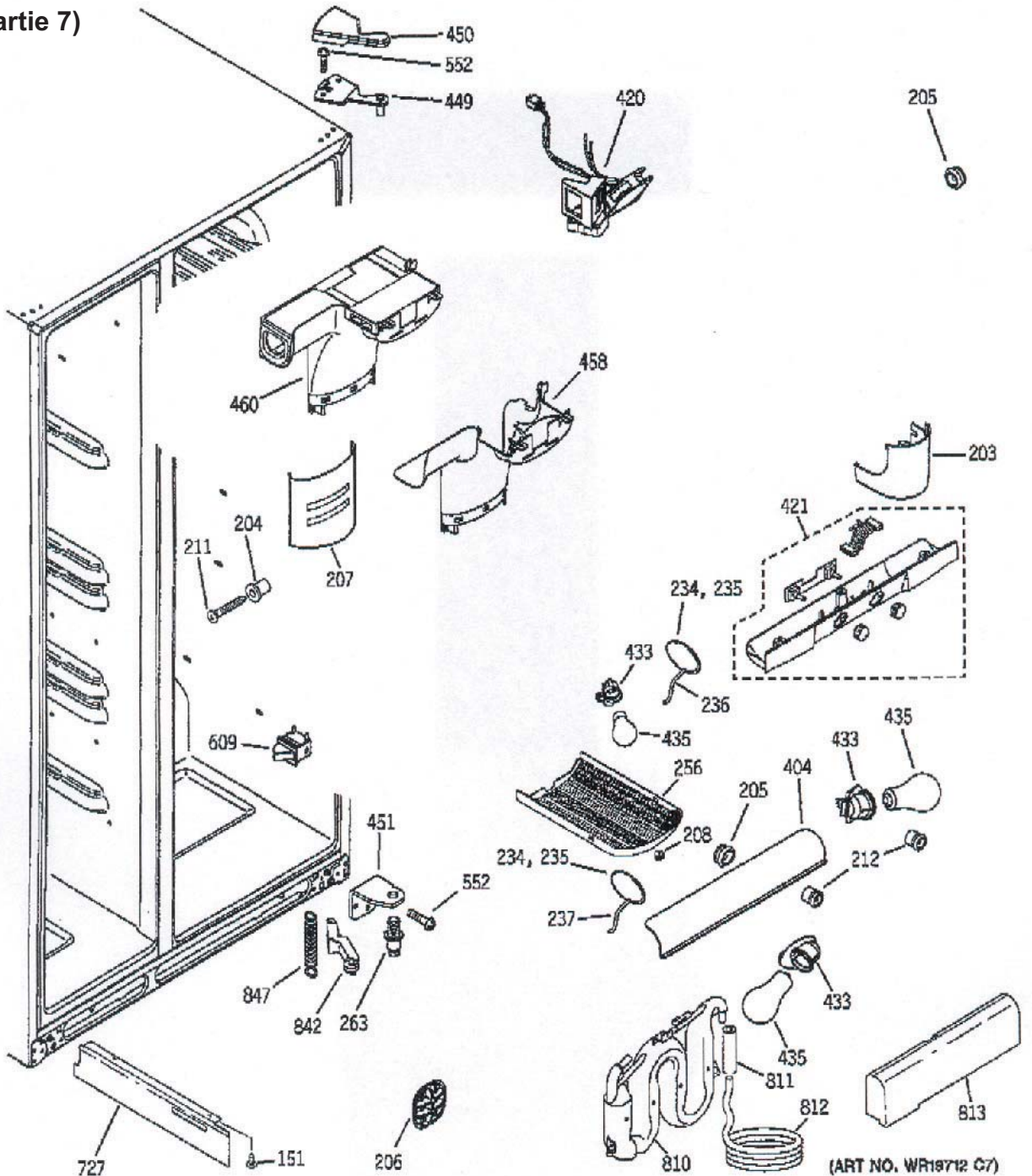

(ART NO. WR19712 C7)

203	WR17X11070	COVER DUCT	420	WR49X10091	FAN & DAMPER ASM FF
204	WR02X12187	SUPPORT SHELF	421	WR55X10470	INTERFACE CUSTOMER ASM
205	WR02X10678	GROMMET	449	WR13X10215	HINGE TOP & PIN FF
206	WR02X10671	GRILLE AIR RETURN	450	WR02X10658	COVER HINGE FF WH
207	WR17X10909	COVER INLET DISCHARGE	451	WR13X10126	HINGE BTM WH
208	WR01X10431	NUT 6-32 UN	458	WR17X10912	COVER FF INLET
211	WR01X10568	SCR 8-18 AB UFL 1 1/2 SS	460	WR49X10091	COVER ASM FF INLET
212	WR02X10689	GROMMET BASE GRILLE	609	WR02X10668	SWITCH LIGHT
234	WR02X10647	GRILLE SENSOR	727	WR17X11503	SEPARATOR AIR HISIDE
235	WR02X10668	SHUNT SENSOR	810	WR17X11440	WATER TANK DISP ASM
236	WR55X10025	SENSOR TEMP FF	811	WR02X11288	INSUL TUBE FOAM
237	WR55X10025	SENSOR TEMP FF	812	WR17X11439	TUBE PLASTIC
256	WR17X10839	SHIELD LIGHT FF	813	WR17X11620	INSULATION TANK FOAM
263	WR02X10648	PIN HINGE BTM ADJ HOLLOW	842	WR11X10007	LEVER ASM FF SIDE WH
404	WR17X11609	DIVERTER FF AIRFLOW			

Réfrigérateur

GCG23YESBFWW

(Partie 8)

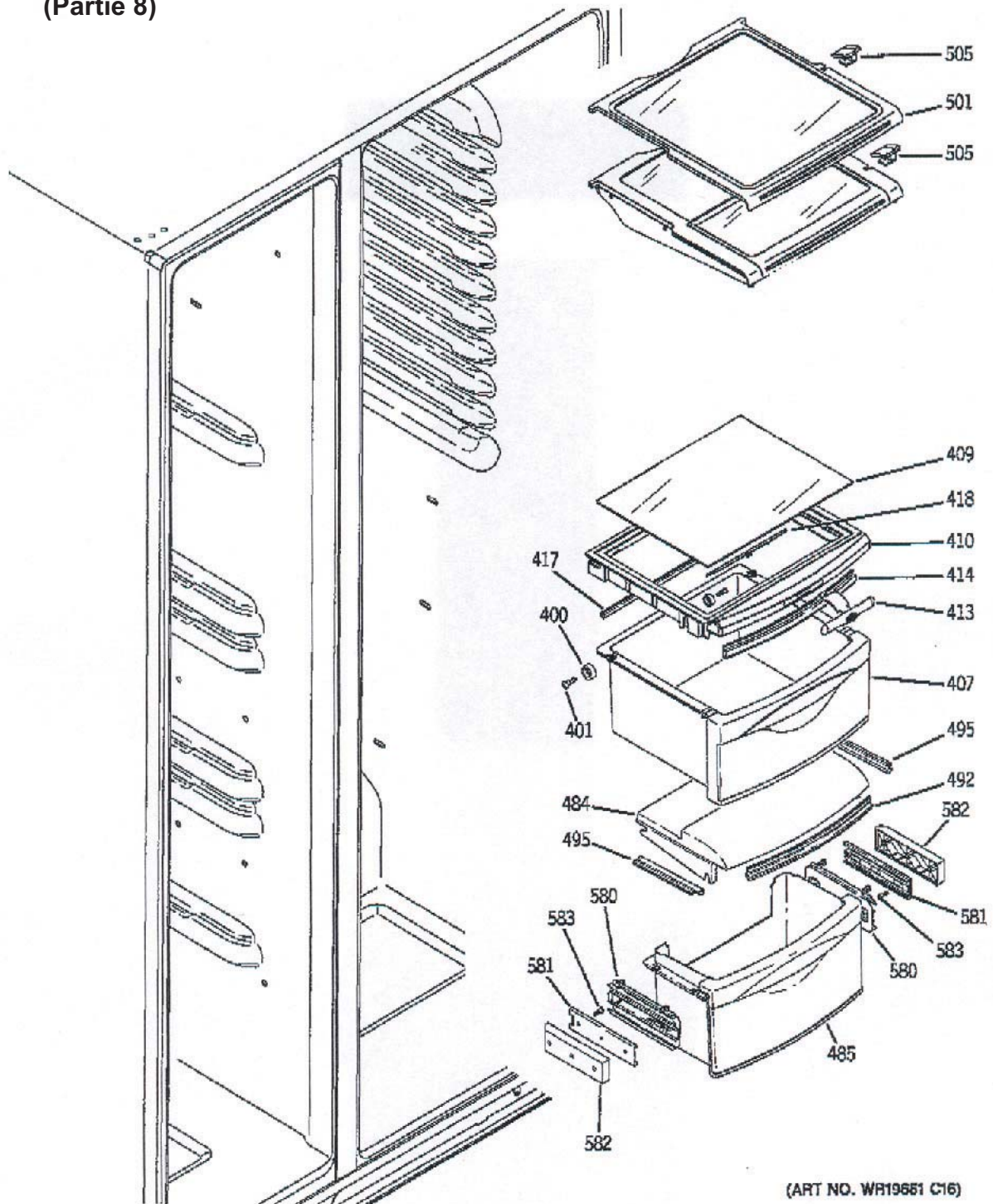

(ART NO. WR19661 C16)

400	WR01X10209	WHEEL PAN COVER	485	WR32X10514	PAN FRAME ASM
401	WR01X10214	SCR 10-16 PL PNP 5/8 SZN	492	WR14X10105	SEAL FRONT CHILL
407	WR32X10370	PAN MIDDLE ASM	495	WR14X10159	SEAL SIDES CHILL
409	WR32X10200	COVER PAN GLASS	501	WR71X10621	SHELF SLIDEOUT ASM
410	WR32X10307	COVER MIDDLE PAN	505	WR02X10662	STOP SHELF
413	WR02X10801	HUMIDITY CONTROL	580	WR72X10193	SLIDE AND BRACKET ASM L
414	WR14X10059	GASKET PAN CRV FRONT	580	WR72X10194	SLIDE AND BRACKET ASM R
417	WR14X10058	GASKET PAN CRV REAR	581	WR72X10195	SLIDE LINER
418	WR02X10633	SLIDE MIDDLE PAN COVER	582	WR72X10142	SPACER SLIDE
484	WR32X10446	COVER PAN ASM	583	WR01X10399	SCR 8-18 AB HW 1/2 S

Réfrigérateur

GCG23YESBFWW

(Partie 9)

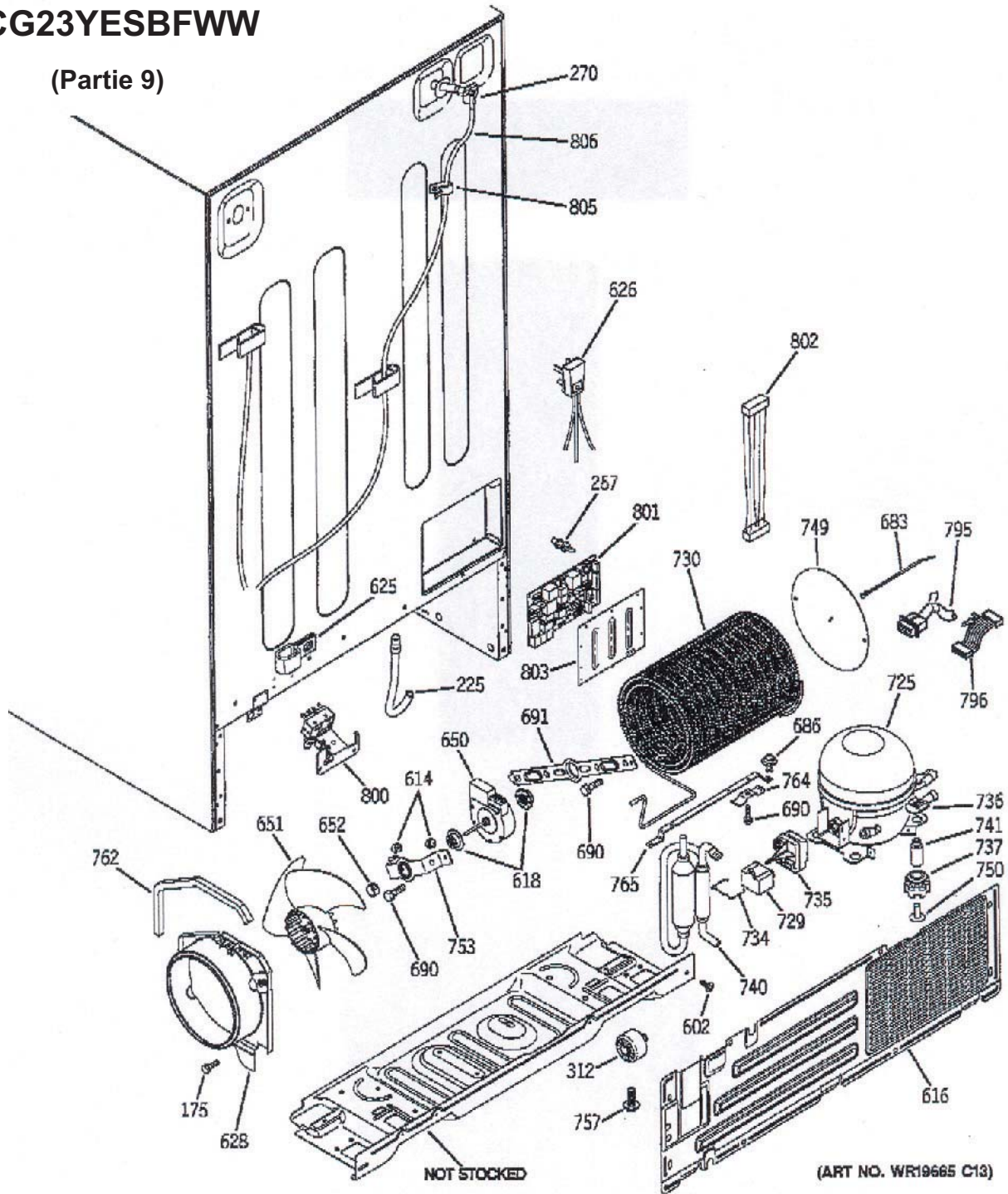

175	WR01X10035	SCR 8-18 AB IHW 5/8 S	729	WR62X10014	CAPACITOR
225	WR02X11426	TUBE DRAIN	730	WR84X10022	CONDENSER ASSEMBLY
257	WR02X10663	STAND OFF	734	WR02X10556	COVER RELAY SNAP (MEI)
270	WR17X11506	GROMMET AND TUBE ASM	735	WR08X10019	OVERLOAD
312	WR02X12000	MOBILITY WHEEL S KIT ASM	737	WR02X10099	GROMMET
614	WR02X10540	BUMPER LID	749	WR17X11039	BAFFLE COND AIR
616	WR82X10100	ACCESS COVER	753	WR02X11863	BRKT COND FAN (MTG)
618	WR02X11331	GROMMET EVAP FAN	757	WR01X10194	SCR 10-32 SPECIAL
626	WR23X10233	CORD POWER ASM	762	WR14X10053	FOAM STRIP SE ADH
628	WR17X11252	SHROUD CONDENSER	765	WR17X10763	BRACKET CONDENSER BAR
650	WR60X10155	MOTOR DC COND FAN	795	WR23X10259	HARNESS DC CAPACITOR
651	WR60X10206	BLADE COND FAN ASM	796	WR23X10260	HARNESS DC CAPACITOR
652	WR02X12149	RING COMPRESSION	800	WR57X10029	WATER VALVE ASM 230V
683	WR02X11027	WIRE TIE	801	WR55X10556	BOARD ASM MAIN CONTROL
686	WR01X10252	SCR 10-32 TT HXW 5/16 S	802	WR23X10504	HARNESS BOARD INDIV
690	WZ5X158D	SCR 8-32 T HXW 3/8 S	803	WR02X12025	MAIN BOARD ENCLOSURE ASM
691	WR02X10593	BRACKET COND FAN (REAR)	806	WR17X11625	TUBE PLASTIC
725	WR87X10103	COMP REPL KIT			