

IGNIS

Service Manual

Horizontal Freezer

AFE 946/G

Model Version		Page
	AFE 946/G	
	8507 946 01001	
	Technical data	2
	Spare part list	3
	Exploded view	4
	Circuit and Wiring diagram	5

Technical data

Dimensions

Height	88.4	cm
Width	112	cm
Depth	64.2	cm

Capacity

gross	327	l
net	320	l

Electrical connection

Voltage	220 - 240	V
Frequency	50	Hz

Power consumption

in 24 hours	1.5	kWh
-------------	-----	-----

Freezing capacity

in 24 hours	23	kg
-------------	----	----

Compressor

Type	EMS 49 HLP	
Capacity (CECOMAF)	112	W

Refrigerant

Type	R 134 a	
Quantity	145	g

Thermostat switching value

Switch on temperature min.	- 14	°C
Switch on temperature max.	- 23.5	°C
Switch off temperature min.	- 20	°C
Switch off temperature max.	- 29.5	°C

Spare part list

Model AFE 946/G
Service No. 850794601001
Version 850794601001

Pos. No.	12NC Code	Description
012 0	4819 462 48259	Foot
041 0	4819 417 19607	Hinge
041 7	4819 462 58187	Cover,hinge
041 8	4819 462 58354	Cover,hinge
071 7	4819 458 58384	Grid,air
101 0	4819 442 69249	Door,freezer
111 0	4819 498 78458	Handle,door
111 1	4819 462 79906	Cover
191 4	4819 468 18201	Gasket
204 3	4819 442 78199	Separator
241 0	4819 458 68203	Basket
252 0	4819 464 18155	Casing
301 0	4819 459 48896	Frame
321 0	4819 381 18108	Lens red
321 1	4819 381 18246	Lens
335 0	4819 411 28789	Knob thermostat
350 0	4819 134 48513	Pilot lamp
402 0	4819 360 38666	Compressor EMS49HLP
493 0	4819 462 88043	Cover
556 0	4819 271 28766	Thermostat A 1082 R4523
561 0	4819 282 28499	Protect,motor AD37FQ4
561 2	4819 290 68406	Connectionblock
614 0	4819 280 68359	Relay PTC+BDG 2019/B
740 0	4819 511 48648	Condenser
740 4	4819 404 49922	Bracket
764 0	4819 480 28144	Dryer
781 0	4819 462 48421	Panel

Exploded view

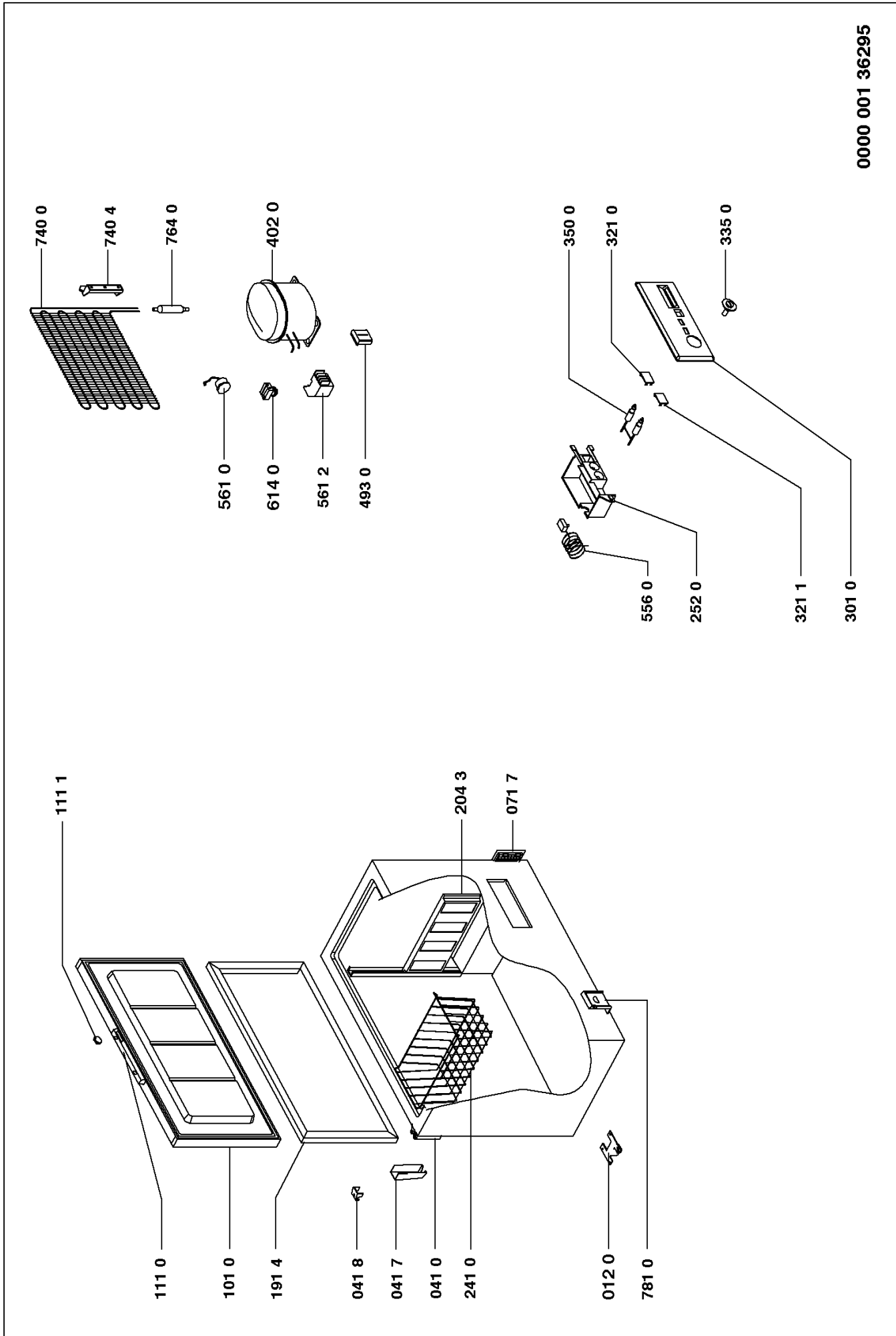

0000 001 36295

Circuit and Wiring diagram

