

ER 151

del ER 151

EXPLODED VIEW

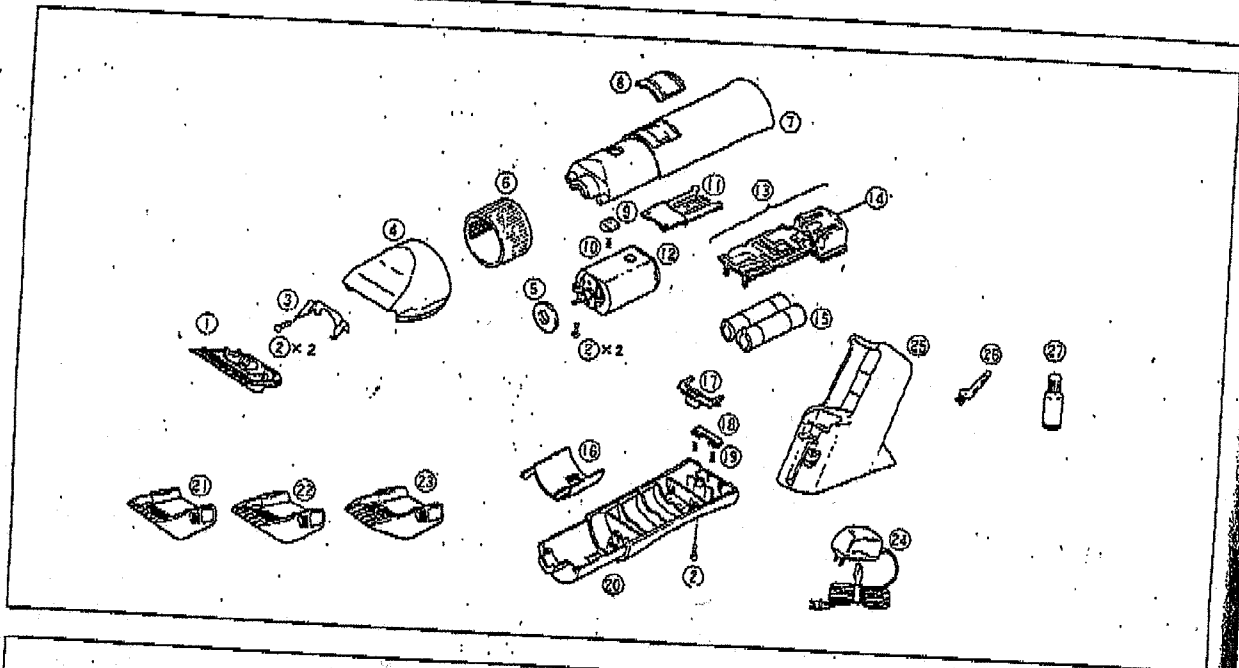

REPLACEMENT PARTS LIST

Ref. No.	Part No.	Part Name & Description	Per set	Remarks
1	WER977Y	BLADE BLOCK		
2	WER150S9208	TAPPING SCREW	1	
3	WER150L0167	SPRING FOR CUTTER	5	
4	WER150S0007	BLADE HOLDER	1	
5	WER150L0137	DUST-PROOF RUBBER	1	
6	WER151H3288	ADJUSTING DIAL	1	
7	WER151H3058	HOUSING A	1	
8	WER150H3207	SWITCH HANDLE	1	
9	WER150L0457	CLICK BUTTON	1	
10	WER150L0177	SPRING A	1	
11	WER150L1577	CLICK PLATE	1	
12	WER150L1007	MOTOR	1	
13	WER150L2107	MODULE	1	
14	WER150K2157	PLUG BLOCK	1	
15	WER150L2507	RECHARGEABLE BATTERY	1	
16	WER150L1587	ADJUSTING ARM	1	
17	WER150K3607	LOCK BUTTON	1	
18	WER150L0207	LOCK PLATE	1	
19	WER150L0197	SPRING B	1	
20	WER151H3068	HOUSING B	1	
21	WER150H7397	COMB ATTACHMENT A	1	
22	WER150H7407	COMB ATTACHMENT B	1	6mm
23	WER150H7417	COMB ATTACHMENT C	1	9mm
24	WER151H7659	POWER CORD UNIT	1	12mm
25	WER150H7188	CHARGING STAND	1	C-2-PLUG
26	WER39887058	CLEANING BRUSH	1	
27	WER78503801	OIL		
-	WER151H8008	INDIVIDUAL BOX		
-	WER151H8108	OPERATING INSTRUCTIONS		

ASCI
 Elektro Service Vertriebs GmbH
 Schachtweg 53
 31036 Elm e
 Tel.: 05182/970970
 Fax: 05182/970971