

Service  
Service  
**Service**



Philips Consumer Lifestyle

# Service Manual

## PRODUCT INFORMATION

### Features

- Color : Caspian Blue
- SteamGlide plus soleplate
- Easy Reach Steam tip
- Steam output (50 gram/min)
- Shot Of Steam, SOS (170 gram/min)
- Vertical SOS
- Spray feature
- Tank capacity (350 ml)
- Cord winder & Velcro
- Cord length (2.5 m)
- Drip stop System
- Double Active Calc System
- Auto Shut Off

### Safety Information

- This product meets the requirements regarding interference suppression on radio and TV.
- After the product has been repaired, it should function properly and has to meet the safety requirements and legal regulations as officially laid down at this moment.

## TECHNICAL INFORMATION

Voltage	: 220 - 240 V
Frequency	: 50 - 60 Hz
Power	: 2200 - 2600 W
Dimension (F-box)	: 130 (D) x 325 (W) x 165 (H) mm
Weight (Product)	: 1.60 kg

### Water Advice

Suitable for tap water use. Advice to mix with equal portion of distilled water or use only distilled water if the tap water is very hard.

### SteamGlide plus soleplate

The specially treated SteamGlide plus soleplate is designed with 2 distinctly different types of steam vents:

1. Large vents for maximum crease removal
2. Fine vents for best glide

### Easy Reach Steam Tip

Concentrated steam delivered in the hard to reach places by pointed shape & the elongated steam slots.

### Double Active Calc System

This is a 2-step system to protect your iron from scale build-up:

1. The anti-calc tablet prevents scale from clogging the steam vents.
2. The calc-clean function flushes out any loose scale particles still inside the iron.

### Drip Stop System

Water is released into the steam chamber via the tank valve when the soleplate temperature is high enough.

When temperature is too low, the tank valve is closed by means of a bi-metal disc.

### Auto Shut Off

The iron shuts off automatically if remain motionless for 30 sec in horizontal position or 8 min in vertical position.

**THERMOSTAT PLATE  
PRINTED 19**

**THERMOSTAT RING 20**

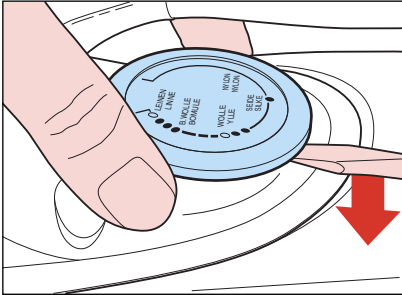

**BACKPLATE 6**

**BALL SWIVEL 7**

**CORDSET 16**

- Remove Screw A
- Remove BACKPLATE 6
- Remove Screws B1, B2

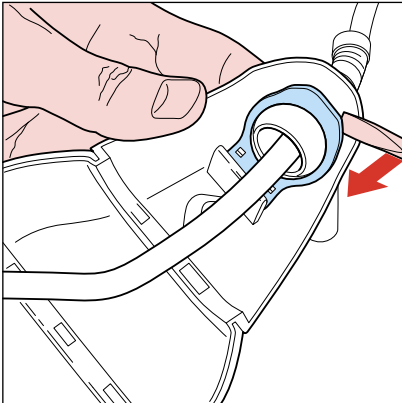

**FILLING DOOR ASSY 9**

**INLAY ASSY 10**

**SOS KNOB 14**

**SPRAY KNOB 15**

**ASO ASSY 17**

- Remove Screw A
- Remove BACKPLATE 6
- Remove INLAY ASSY 10

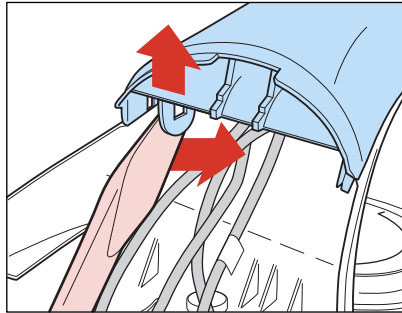

**STEAM SLIDER 11**

**WATER TANK ASSY 12**

**HOUSING 13**

**THERMOSTAT BUSH 18**

- Remove Screw A
- Remove BACKPLATE 6
- Remove INLAY ASSY 10
- Remove SOS KNOB 14
- Remove SPRAY KNOB 15
- Remove THERMOSTAT PLATE PRINTED 19
- Remove THERMOSTAT RING 20
- Remove Screws D1, D2
- Remove Screws E1, E2
- Remove HOUSING 13
- Remove Screws F1, F2
- Remove WATER TANK ASSY 12

**RYTON SPACER 3**

**DOSING SEAL 4**

**HEAT SHIELD 5**

- Remove Screw A
- Remove BACKPLATE 6
- Remove INLAY ASSY 10
- Remove SOS KNOB 14
- Remove SPRAY KNOB 15
- Remove Screw E1
- Remove Screws F1, F2
- Remove WATER TANK ASSY 12
- Remove Screws G1, G2, G3
- Remove HEAT SHIELD 5
- Remove COVER SPRAYED 1

- Due to the high wattage of the iron, only the specified cord set must be used.
- Should damage be observed on the **CORDSET 16**, it must be replaced. Continued usage is not allowed.
- If **COVER 1** is provided without type plate information eg. type number, voltage etc. When replacing the cover, engrave the type number & voltage on the type plate with a sharp object.
- After the product has been repaired, it should function properly and has to meet the safety requirements & legal regulations as laid down & officially established at this moment.
- The following tests are common checks that are conducted on a repaired product before it is returned to the consumer.

**1. Soleplate temperature**

Check that soleplate temperature is within IEC requirement.

Measure the temperature of the soleplate after the iron has reached steady state i.e connected to the mains for at least 15 minutes. The table below shows the temperature requirement.

Marking	Soleplate temperature (Deg C)			Material, for example
	Minimum	Maximum	Nominal + Tolerance	
• (1 dot)	70	120	95 ± 25	Acetate, elastane, polyamide, polypropylene
•• (2 dots)	100	160	130 ± 30	Cupro, polyester, silk, triacetate, viscose, wool
••• (3 dots)	140	210	175 ± 35	Cotton, linen

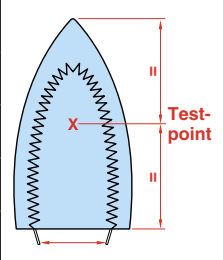

**2. Leakage current**

Check that leakage current is within IEC requirement.

Measure leakage current between LIVE/NEUTRAL & EARTH.

IEC requirement is that at 230 V supply, the EARTH leakage current must be less than 0.75 mA.

**3. Water leakage / Functionality**

Check that there is no water leakage from any part of the product during operation.

Check that the functionality of the product (product dependent) eg. steaming, variable steam, SOS, ASO etc is working properly.

**4. Loose part**

Check that there are no loose parts eg. extra screw in the product that can cause short-circuit or product malfunction.

Pos	Service code	Description
1	4239 015 44871	Cover inscribed
2	4239 021 58671	Soleplate mounted assy 230 V / 2400 W
3	4239 025 98250	Ryton spacer
4	4239 015 58891	Dosing seal
5	4239 010 08970	Heat shield
6	4239 026 40451	Backplate
7	4239 026 41261	Ball swivel
8	4239 026 40491	Backplate cover
9	4239 021 59091	Filling door assy
10	4239 021 59661	Inlay assy
11	4239 026 40921	Steam slider
12	4239 021 59521	Water tank assy
13	4239 021 59561	Housing assy
14	4239 026 40841	SOS knob
15	4239 026 40881	Spray knob
16	4239 000 11111	Cordset EU
17	4239 021 59161	ASO assy 230 V
18	4239 026 17320	Thermostat bush
19	4239 021 60171	Thermostat plate printed - Eng
20	4239 026 40251	Thermostat ring
21	4239 026 05990	Filling cup

