

# 9.2 EXTERIOR SECTION

A  
B  
C  
D  
E  
F

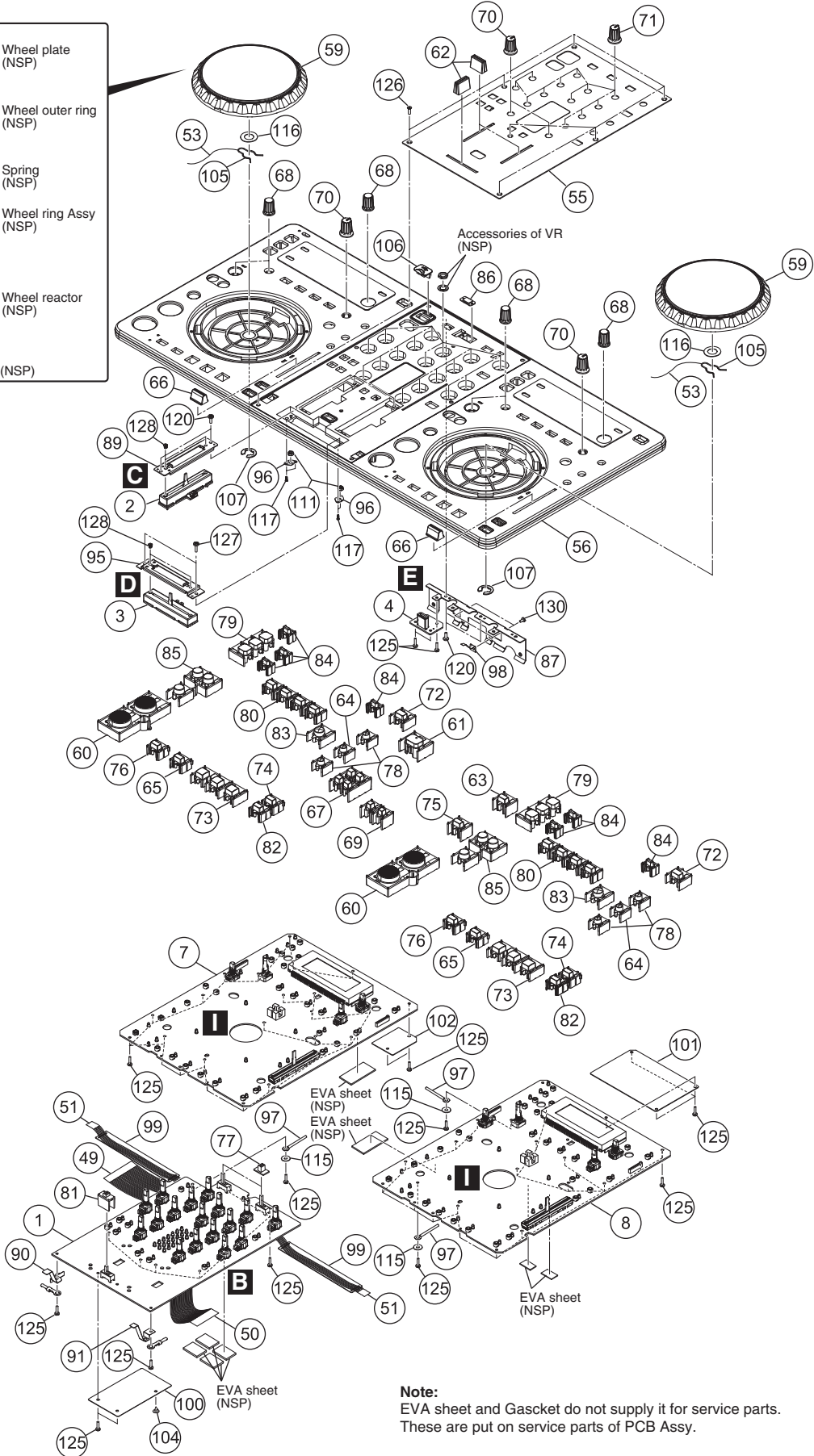

**Note:**  
EVA sheet and Gascket do not supply it for service parts.  
These are put on service parts of PCB Assy.

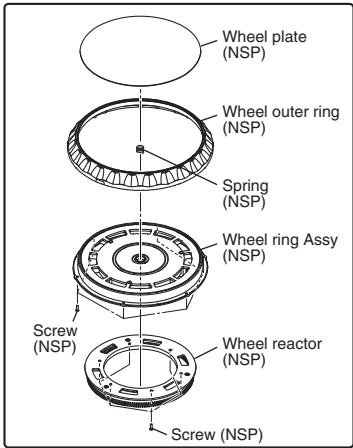
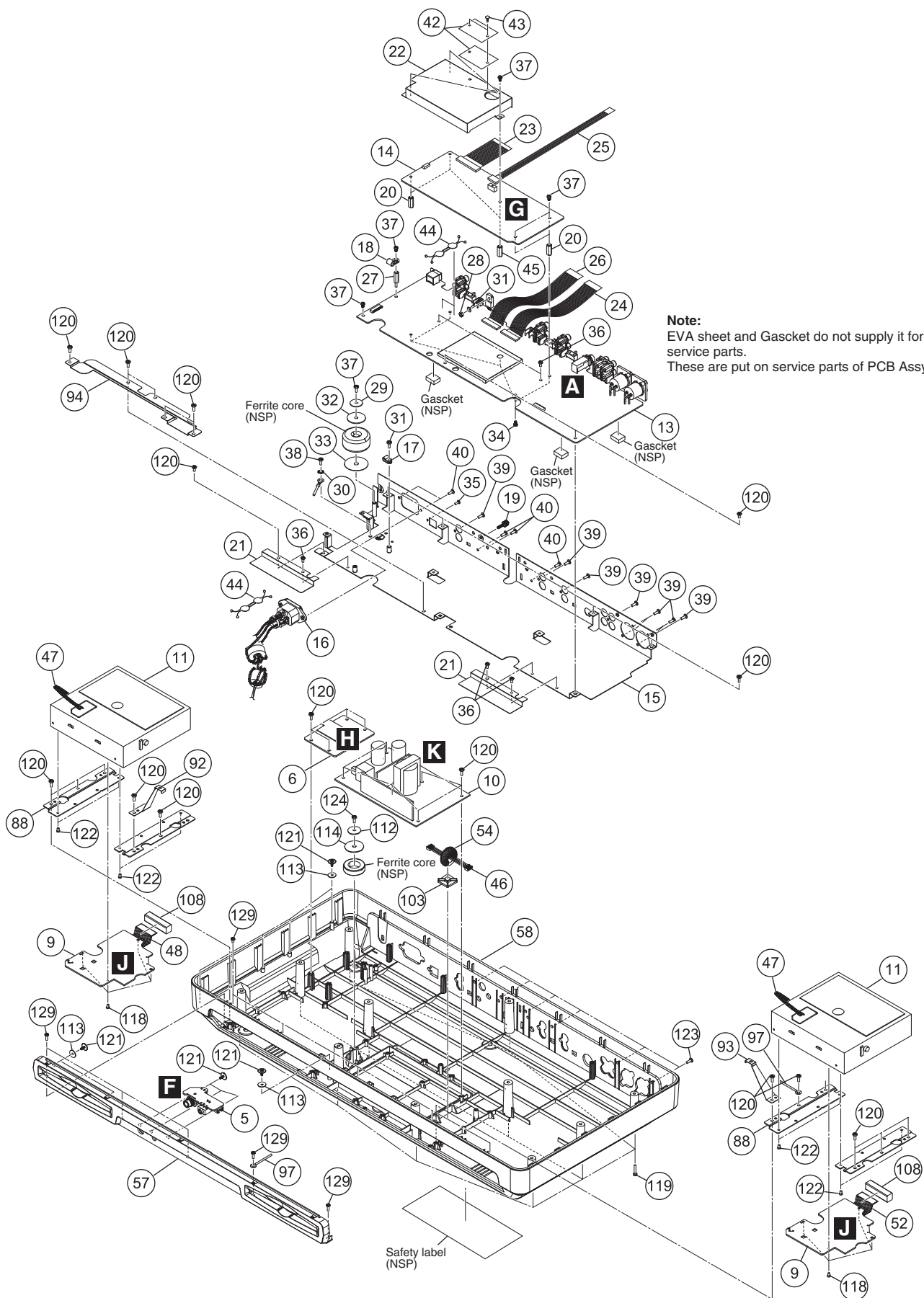

**Note:**  
 EVA sheet and Gasquet do not supply it for service parts.  
 These are put on service parts of PCB Assy.

Safety label (NSP)

**(1) EXTERIOR SECTION PARTS LIST**

<u>Mark No.</u>	<u>Description</u>	<u>Part No.</u>	<u>Mark No.</u>	<u>Description</u>	<u>Part No.</u>
A	1 MIXER Assy	704-COMBO-A376	46	4P Wire	404-COMBO-3772
	2 CH Assy	704-COMBO-A482	47	3P Wire	404-UJ300KM-3644-HA
	3 CROSS FADER Assy	704-COMBO-A499	48	28P FFC Cable	406-COMBO-1245
	4 USB Assy	704-COMBO-A381	49	38P FFC Cable	406-COMBO-1249
	5 PHONES Assy	704-COMBO-A379	50	36P FFC Cable	406-COMBO-1250
	6 Wi-Fi PCB Assy	704-COMBO-A380	51	8P FFC Cable	406-COMBO-1251
	7 CD1 Assy	704-COMBO-A375	52	28P FFC Cable	406-MEP4-1201-HA
	8 CD2 Assy	704-COMBO-A476	53	Wire	406-S100-031
	9 SERVO Assy	704-COMBO-A377	54	Ferrite Core	415-VP9812-221-HA
	10 SWITCHING POWER	411-COMBO-887	55	Mixer Panel Assy	703-XDJR1-1394
B	11 SLOT-IN FEEDER MECHA Assy	704-MCU300-9997-HA	56	Chassis Assy	701-XDJR1-5329
	12 •••••		57	Front Panel Assy	701-COMBO-5204
	13 I/O Assy	704-COMBO-A378	58	Base Assy	See Contrast table (2)
	14 DSP & POWER Assy	704-COMBO-A531	59	Wheel & Shaft Assy	701-COMBO-5294
	15 Rear Board Assy	703-COMBO-1377	60	PLAY/CUE Button	701-XDJR1-5325
	⚠ 16 AC Socket Assy	704-COMBO-A483	61	USB Button Assy	701-XDJR1-5326
	17 Cord Bush	100-SDJ2-2553	62	Push Button	100-22-2824-HA
	18 Cord Bush	100-K1-2682-HA	63	AUX Button	100-AUX-2975
	19 Ground Terminal	200-100U-527	64	Round Button	100-BLACK-2968S
C	20 Hexagon Pillar	200-COMBO-668	65	CALL Button	100-CALL-2967A
	21 Isolation Plate	300-COMBO-2063	66	Push Knob	100-CMX4-2906-HA
	22 Isolation Plate	300-COMBO-2075	67	Color Button	100-COLOR-2973S
	23 26P FFC Cable	406-COMBO-1244	68	Encoder Knob	100-COMBO-2962
	24 24P FFC Cable	406-COMBO-1247	69	CUE Button	100-CUE-2974
	25 8P FFC Cable	406-COMBO-1248	70	Rotary Knob	100-DJM100-2826-HA
	26 24P FFC	406-COMBO-1255	71	Rotary Knob	100-DJM250-2826-HA
	27 Spacer Support	504-COMBO-302	72	Eject Button	100-EJECT-2970
	28 Nut (M3*P0.5)	601-A100-004-HA	73	HOTCUE Button	100-HOTCUE-2971S
D	29 Fixed Center Washer	606-C426-066	74	MASTER Button	100-MASTER-2967A
	30 Washer	606-4500-123	75	MIC Button	100-MIC-2975
	31 Nylon Washer	606-500C-265	76	MODE Button	100-MODE-2967A
	32 Washer	606-COMBO-266	77	Push Button	100-MX200-2706-HA
	33 Washer	606-COMBO-267	78	Round Button	100-ROUND-2968
	34 Screw	602-B300-041-HA	79	Source Button	100-SOURCE-2966
	35 Screw	602-DD2220-301-HA	80	SQUARE Button	100-SQUARE-2967
	36 Screw	602-SA12-377-HA	81	Push Button	100-SW-2980S
	37 Screw	602-SA12-380-HA	82	SYNC Button	100-SYNC-2967A
E	38 Screw	602-ISOB408-543C	83	TAP Button	100-TAP-2969
	39 Screw	602-PTS308-732B	84	TINY Button	100-TINY-2965S
	40 Screw	602-ISO308-735B	85	TRACK Button	100-TRACK-2964
	41 •••••		86	Wi-Fi Lens	100-WIFI-2979
	42 Electrical Tape	501-COMBO-2216	87	Transfer Plate	300-COMBO-2034
	43 Canoe Clips (MB-1S)	504-HF6011-5011	88	Mecha Fixed Plate	300-COMBO-2036
	44 Fixed Loop (2A-8)	504-COMBO-300	89	CH Fixed Plate	300-COMBO-2038
	45 Spacer Support	504-QFX-204	90	Ground Plate L	300-COMBO-2064

<u>Mark No.</u>	<u>Description</u>	<u>Part No.</u>	
91	Ground Plate R	300-COMBO-2065	
92	Ground Plate L	300-COMBO-2066	
93	Ground Plate R	300-COMBO-2067	A
94	Join Plate	300-COMBO-2072	
95	Fixed Plate	300-DJM100-1960-HA	
96	Cover	300-DMX101-1993	
97	Locking Cable Clip	300-HM510B-224	
98	Ground Plate	300-SPINU2-1692	
99	Isolation Slice	501-COMBO-2554	
100	Isolation Slice	501-COMBO-2555	
101	Segregate Sheet	501-COMBO-2564	
102	Segregate Sheet	501-COMBO-2568	B
103	Adhesive Mount	504-HDJ7000-032	
104	Canoe Clips	504-HF6011-5011	
105	Spring	603-C304-335	
106	USB Cap	604-COMBO-605	
107	E Ring	606-C304-209	
108	Sponge	612-COMBO-462	
109	.....		
110	.....		
111	Nut	601-A100-004-HA	C
112	Fixed Center Washer	606-C426-066	
113	Washer	606-COMBO-264	
114	Washer	606-COMBO-266	
115	Washer	606-KMD280-081-HA	
116	Washer	606-RMP25-257	
117	Screw	602-A700-494-HA	
118	Screw	602-DD2220-301-HA	
119	Screw	602-DJ3000-272	
120	Screw	602-DJ5500-452-HA	D
121	Screw	602-DV300-5023	
122	Screw	602-H888F-308-HA	
123	Screw	602-ISO308-735B	
124	Screw	602-MK7-131-HA	
125	Screw	602-MK8-604	
126	Screw	602-PTF2609-710B	
127	Screw	602-SA12-380-HA	
128	Screw	602-SA12-414	
129	Screw	602-SL24F-099	E
130	Screw	602-ST150-431	

## (2) CONTRAST TABLE

XDJ-R1/SVWYXE8, CUXE, FLWPWXE, KXE5 and AXE5 are constructed the same except for the following:

Mark	No.	Symbol and Description	XDJ-R1 /SVWYXE8	XDJ-R1 /CUXE	XDJ-R1 /FLWPWXE	XDJ-R1 /KXE5	XDJ-R1 /AXE5
	58	Base Assy	701-COMBO-5206	701-COMBO-5205	701-COMBO-5340	701-COMBO-5339	701-COMBO-5338