

## 5. REPAIR PARTS LIST

### HARDWARE LIST

#### 5-1-7. LCD PANEL BLOCK

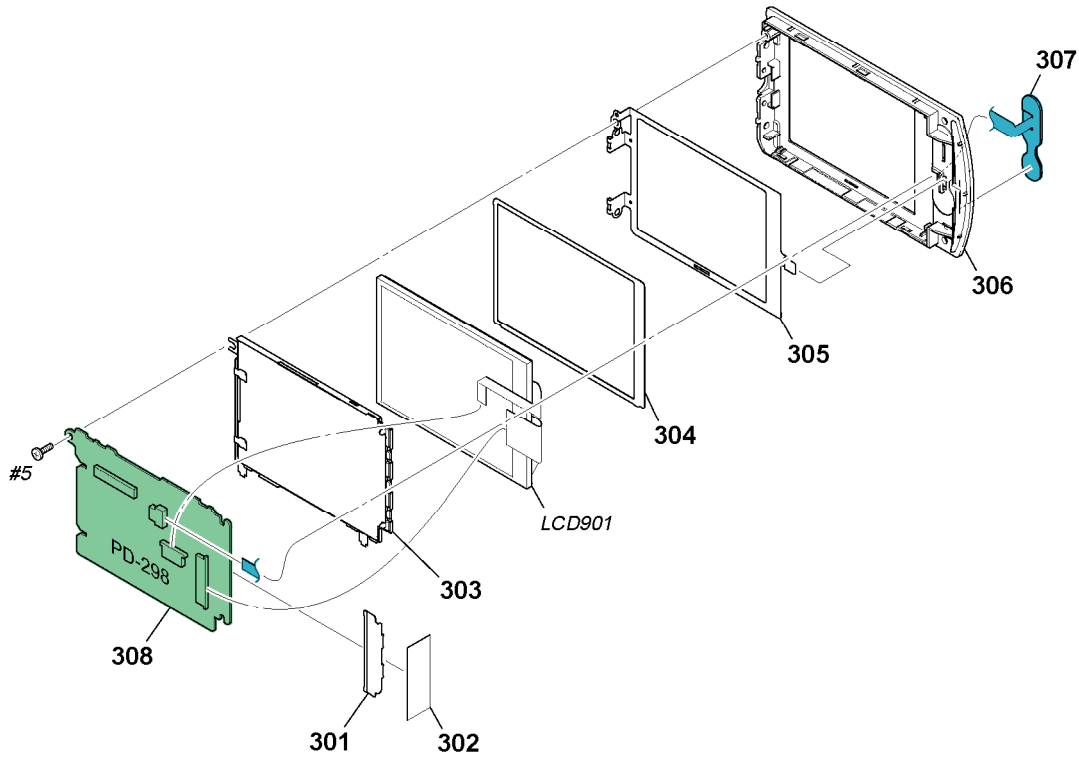

Ref. No.	Part No.	Description
* 301	2-638-780-01	CLIP
* 302	2-668-085-01	SHEET, P
303	A-1153-903-A	LIGHT GUIDE BLOCK (2.5)
* 304	2-697-369-01	CUSHION (730), PANEL
* 305	2-697-366-01	PLATE (730), P GROUND

Ref. No.	Part No.	Description
306	2-697-365-01	CABINET (M) (730), P
307	1-479-063-21	KEY BLOCK, CONTROL (SB9000)
308	A-1202-680-A	PD-298 BOARD, COMPLETE
LCD901	A-1202-054-A	TP BLOCK ASSY (25ESTGU06)
#5	3-080-204-01	SCREW, TAPPING, P2 (Black)