

# SEC 1. DISASSEMBLY/PART NUMBER INFORMATION

## 1-1. TABLE-TOP STAND ASSEMBLY REMOVAL

- Ⓐ Lift up Bottom Cover to detach from Rear Cover
- Ⓑ Remove 4 screws from Table-Top Stand Assembly
- Ⓒ Lift up TV set to detach from Table-Top Stand Assembly

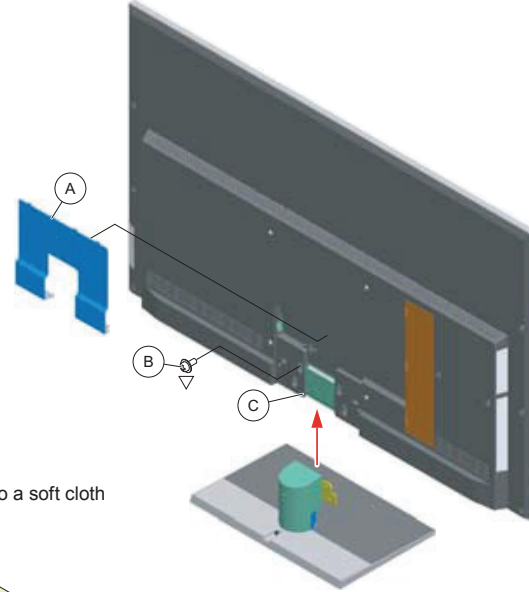

- Ⓓ Gently place the TV set face down onto a soft cloth

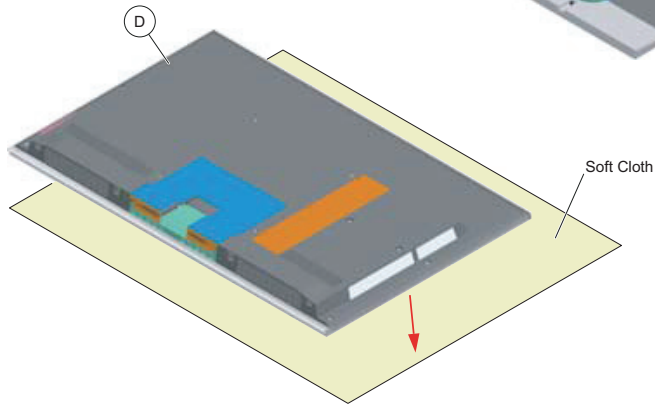

Components not identified by a part number or description are not stocked because they are seldom required for routine service.

The component parts of an assembly are indicated by the reference numbers in the far right column of the parts list and within the dotted lines of the diagram.

\* Items marked with an asterisk are not stocked since they are seldom required for routine service. Expect some delay when ordering these components.

NOTE: The components identified by shading and  $\triangle$  mark are critical for safety. Replace only with part number specified.

NOTE: Les composants identifiés par un trame et une marque  $\triangle$  sont critiques pour la sécurité. Ne les remplacer que par une pièce portant le numéro spécifié.

NOTE: The components identified by a red outline and a  $\nabla$  mark contain confidential information. Specific instructions must be adhered to whenever these components are repaired and/or replaced. See Appendix A: Encryption Key Components in the back of this manual.

Check the [Sony Electronics Service Information](#) website for any additional service related issues for this model.)

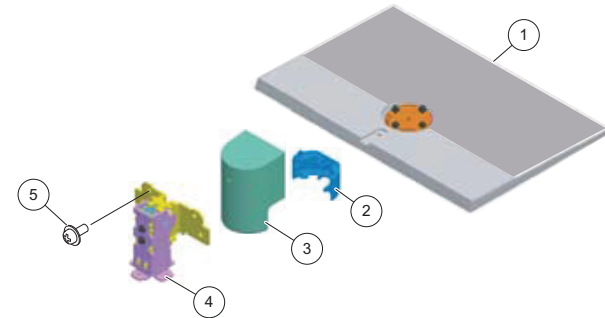

REF. NO.	PART NO.	DESCRIPTION	[ASSEMBLY INCLUDES]	REF. NO.	PART NO.	DESCRIPTION	[ASSEMBLY INCLUDES]
1	X-2546-092-1	BASE (L1A) ASSEMBLY (KDL-46NX800 ONLY)		4	4-170-445-01	NECK (ML1) (KDL-46NX800 ONLY)	
1	X-2546-093-2	BASE (LL1A) ASSEMBLY (KDL-52NX800 ONLY)		4	4-170-446-01	NECK (LL1) (KDL-52NX800 ONLY)	
1	X-2546-094-2	BASE (LLL1A) ASSEMBLY (KDL-60NX800/60NX801 ONLY)		4	4-170-452-01	NECK (LLL3A) (KDL-60NX800/60NX801 ONLY)	
2	4-170-474-01	COVER, NECK (ML1 FRONT) (KDL-46NX800 ONLY)		5	2-580-608-01	SCREW, +PSW M5X16 (SCREWS TO ATTACH TABLE-TOP STAND TO LCD TV)	
2	4-170-475-01	COVER, NECK (LL1 FRONT) (KDL-52NX800 ONLY)				For product protection and safety reasons, Sony strongly recommends that you use the screws provided with the TV	
2	4-170-476-01	COVER, NECK (LLL3A FRONT) (KDL-60NX800/60NX801 ONLY)				<b>CAUTION:</b> These screws cannot be used to secure the TV to the Wall Mount Brackets	
3	4-170-481-01	COVER, NECK (ML1 REAR) (KDL-46NX800 ONLY)		$\nabla$	2-580-608-01	SCREW, +PSW M5X16	
3	4-170-482-01	COVER, NECK (LL1 REAR) (KDL-52NX800 ONLY)					
3	4-170-483-01	COVER, NECK (LLL1 REAR) (KDL-60NX800/60NX801 ONLY)					