

# EXPLODED VIEW

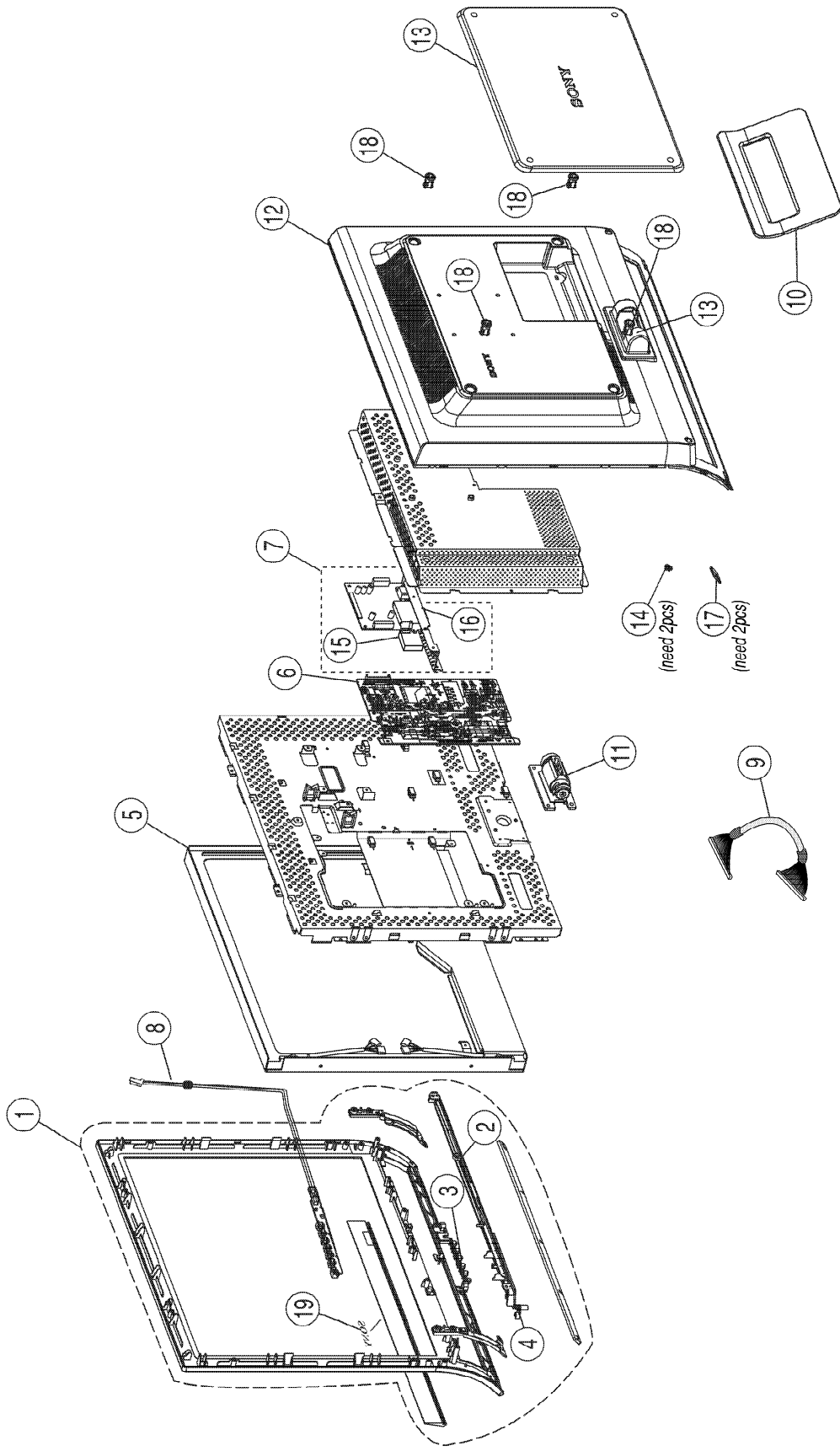

## EXPLODED VIEW PARTS LIST

| Ref. No.                        | Part No.     | Description                        |
|---------------------------------|--------------|------------------------------------|
| 1                               | X-2050-647-1 | BEZEL ASSY (Silver)                |
|                                 | X-2050-829-1 | BEZEL ASSY (Black)                 |
| 2                               | 2-588-346-01 | BUTTON BRAKET                      |
| 3                               | 2-588-343-01 | MULTI BUTTON                       |
| 4                               | 2-588-344-01 | POWER BUTTON                       |
| 5                               | 1-805-826-11 | LCD PANEL (LPL)                    |
| 6                               | 1-789-179-11 | MOUNTED PWB, G (LPL)               |
| 7                               | 1-789-190-11 | MOUNTED PWB, A (LPL)               |
| 8                               | 1-789-191-11 | MOUNTED PWB, H (LPL)               |
| 9                               | 1-900-275-71 | CONNECTOR ASSY                     |
| 10                              | X-2050-652-1 | STAND ASSY                         |
| 11                              | X-2050-654-1 | HINGE ASSY                         |
| 12                              | X-2050-649-1 | BACK CABINET ASSY                  |
| 13                              | 2-588-893-01 | REAR COVER (Silver)                |
|                                 | 2-588-893-11 | REAR COVER (Black)                 |
| 14                              | 2-591-627-01 | SCREW COVER                        |
| 15                              | 1-819-276-11 | AC INLET                           |
| 16                              | 2-588-347-01 | METAL BRAKET                       |
| 17                              | 2-591-628-01 | FRONT FOOT RUBBER                  |
| 18                              | 2-593-157-01 | RUBBER BUSHING                     |
| 19                              | 4-095-995-21 | SONY BADGE (No.6)                  |
| ACCESSORIES & PACKING MATERIALS |              |                                    |
| 20                              | 1-827-120-11 | POWER-SUPPLY CORD SET (AEP), Black |
|                                 | 1-827-122-11 | POWER-SUPPLY CORD SET (CH), Black  |
| 21                              | 1-827-757-11 | D-SUB CABLE                        |
| 22                              | 4-102-356-21 | CD-ROM                             |
| 23                              | 2-583-747-11 | QUICK SETUP GUIDE (AEP, CH)        |