



Service Manual

Microwave oven

AMW 460 IX

Model Version		Page
	AMW 460 IX 8587 460 99793	
	Introduction safety	2
	Technical data	3
	Spare part list	4
	Exploded view	5
	Wiring diagram	6 - 7

Introduction safety

INTRODUCTION

Before leaving the factory each oven is carefully checked.
It must, however, be installed and used correctly.

Despite all the steps taken to make the oven safe, the safety is dependent on the correct installation and the fact the user understands how to use and maintain the oven.

The information in this section should be used as a reminder that the oven is safe and that anyone who uses it must first read the instructions for use in order to be able to use the oven correctly and obtain best results.

SAFETY

To avoid injury to yourself and damage to the appliance always work to the following rules when servicing an oven.

Always disconnect the plug from the mains before starting work.

If there is no plug switch off the electric supply at the control box.

When you have finished servicing an oven before you reconnect it to the mains, make sure that:

- all the internal connections are correct
 - the wires are insulated and not touching the door or the cabinet or anything sharp
 - all the earth connections are electrically and mechanically sound
 - do not modify or anyway interfere with the safety devices built-in to the oven
- make sure that each replacement part you use conforms to the manufacturer's specifications

Do not start a repair if you have any doubt as to your ability to complete it.

CAUTION - MICROWAVE RADIATION

PERSONNEL SHOULD NOT BE EXPOSED TO THE MICROWAVE ENERGY WHICH MAY RADIATE FROM THE MAGNETRON, WAVEGUIDE OR ANTENNA IF THEY ARE IMPROPERLY USED OR CONNECTED. ALL INPUT AND OUTPUT MICROWAVE CONNECTIONS, WAVEGUIDES, FLANGES AND GASKETS MUST BE SECURE. NEVER OPERATE THE DEVICE WITHOUT A MICROWAVE ENERGY ABSORBING LOAD ATTACHED. NEVER LOOK INTO AN OPEN WAVEGUIDE OR ANTENNA WHILE THE DEVICE IS ENERGIZED. NEVER OPERATE AN OVEN WITH CABINET OFF WITHOUT MEASURING THE MICROWAVE LEAKAGE AROUND MAGNETRON AND VISIBLE MICROWAVE CONNECTIONS (WELDING JOINTS).

Do not operate the oven if the following conditions exist:

- the door does not close firmly against the door support because of the door being warped or the hinges damaged.
- The door trims or seals are damaged.
- If there is any visible damage to the oven.
- if the door does not close properly.

Avoid operating the oven if known components in the interlock system, oven door or microwave generating assembly are known defective. They must be replaced.

WARNING - HIGH VOLTAGE

IT IS POSSIBLE TO COME IN CONTACT WITH LETHAL HIGH VOLTAGE WHEN WORKING WITH HV TRANSFORMER, HV CAPACITOR AND MAGNETRON. THEREFORE NEVER TRY TO MEASURE THE HIGH VOLTAGE. ALWAYS TAKE UTMOST CARE WHEN PERFORMING ELECTRIC MEASUREMENTS INSIDE THE OVEN.

Technical data

Product dimensions

Height	382	mm
Width	595	mm
Depth	320	mm

Cavity dimensions

Height	187	mm
Width	370	mm
Depth	290	mm
Cavity volume	22	l
Turntable diameter	250	mm

Weight

Net	19	kg
Gross	21.5	kg

Electrical

Voltage	230	V
Frequency	50	Hz
Fuse	10	A

Power

Power consumption	1300	W
Output power MW 4 power levels	750	W

Error codes

Certain fault conditions are indicated by an error code.
The following codes are implemented:

Error code	Description
ERR d	NTC overheat protection on the magnetron is faulty (not connected or short circuit).
ERR 1	Short circuit in MW relay.
ERR 3	Key error when one of the buttons is pressed longer than 1 minute.

Spare part list

Model AMW 460 IX
Service No. 858746099793
Version 858746099793

Pos. No.	12NC Code	Description
001 0	4812 440 11126	Cabinet
001 1	4812 442 29204	Panel cavity
041 0	4812 417 19181	Hinge screw
100 0	4812 442 69503	Door cpl. INOX
130 0	4812 310 38748	Fixation system 60cm
130 1	4812 310 38739	Switch holder
130 2	4812 310 38782	Cam plate
130 5	4812 492 68172	Spring, tension
244 1	4819 466 89229	Cover for food
255 0	4812 466 78412	Turntable
264 0	4812 535 78092	Ring turntable
264 1	4812 462 38249	Crosspiece turntable
305 0	4812 404 78634	Cover plate PCB
320 0	4812 453 59796	Control panel IN 50cm
332 2	4812 282 19533	Timer button
333 0	4812 404 78751	Button assy IN
350 0	4812 209 88065	Display board
352 0	4812 130 38721	Display
404 0	4812 131 58813	Magnetron
406 0	4812 361 58419	Motor TT
406 1	4819 532 68686	Gasket ring for TT
406 3	4819 502 18402	Screw
412 0	4812 145 28019	Transformer HT
412 1	4812 256 38006	Support transformer
420 0	4812 121 58148	Capacitor 1,05µ F
421 0	4812 122 08001	Filter, mains
426 0	4812 218 38134	Diode HV
440 0	4812 361 18441	Motor, fan kit cpl.
440 1	4812 462 38176	Air guide deflector
490 0	4812 321 18204	Cable mains
490 1	4819 401 18494	Clamp
500 0	4812 214 79048	Control board
561 0	4812 282 48277	Thermostat
562 0	4812 282 48278	Thermostat
611 0	4812 280 68369	Relay G5PA-1-WP 24V
612 0	4812 121 18192	Relay
633 0	4812 271 38395	Switch, door
651 0	4812 134 88055	Lamp
656 0	4819 462 58335	Reflector
691 0	4812 210 78032	Sensor temp.
774 0	4812 442 29206	Plate mica
774 1	4812 491 48016	Pin for micaplate
900 3	4812 310 38743	Stopper door
971 0	4819 252 28125	Fuse T10A
971 1	4819 256 38016	Bracket for fuse
972 0	4819 252 28132	Fuse T160mA
993 0	4812 462 18208	Holder baby bottle

Exploded view

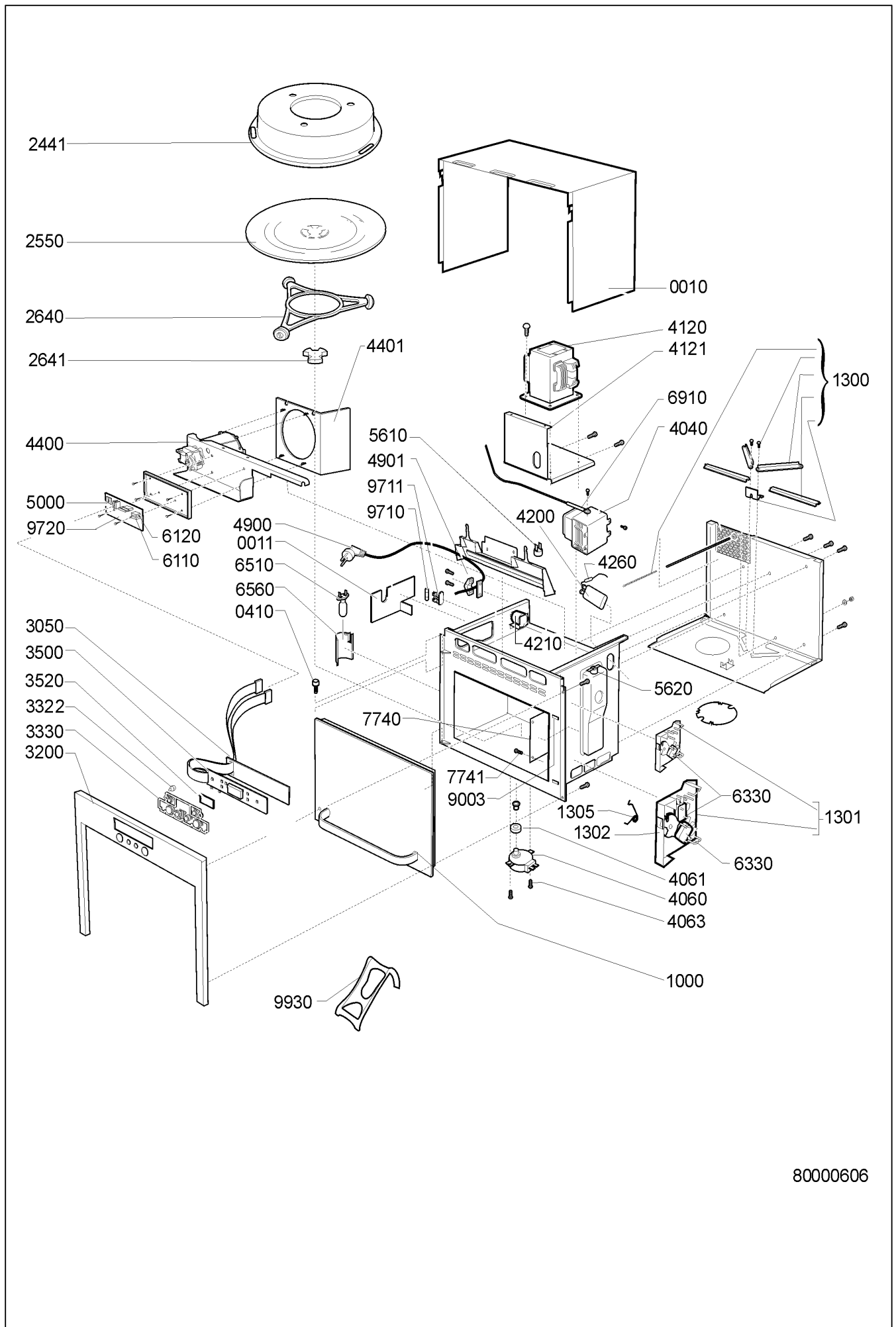

80000606

Wiring diagram

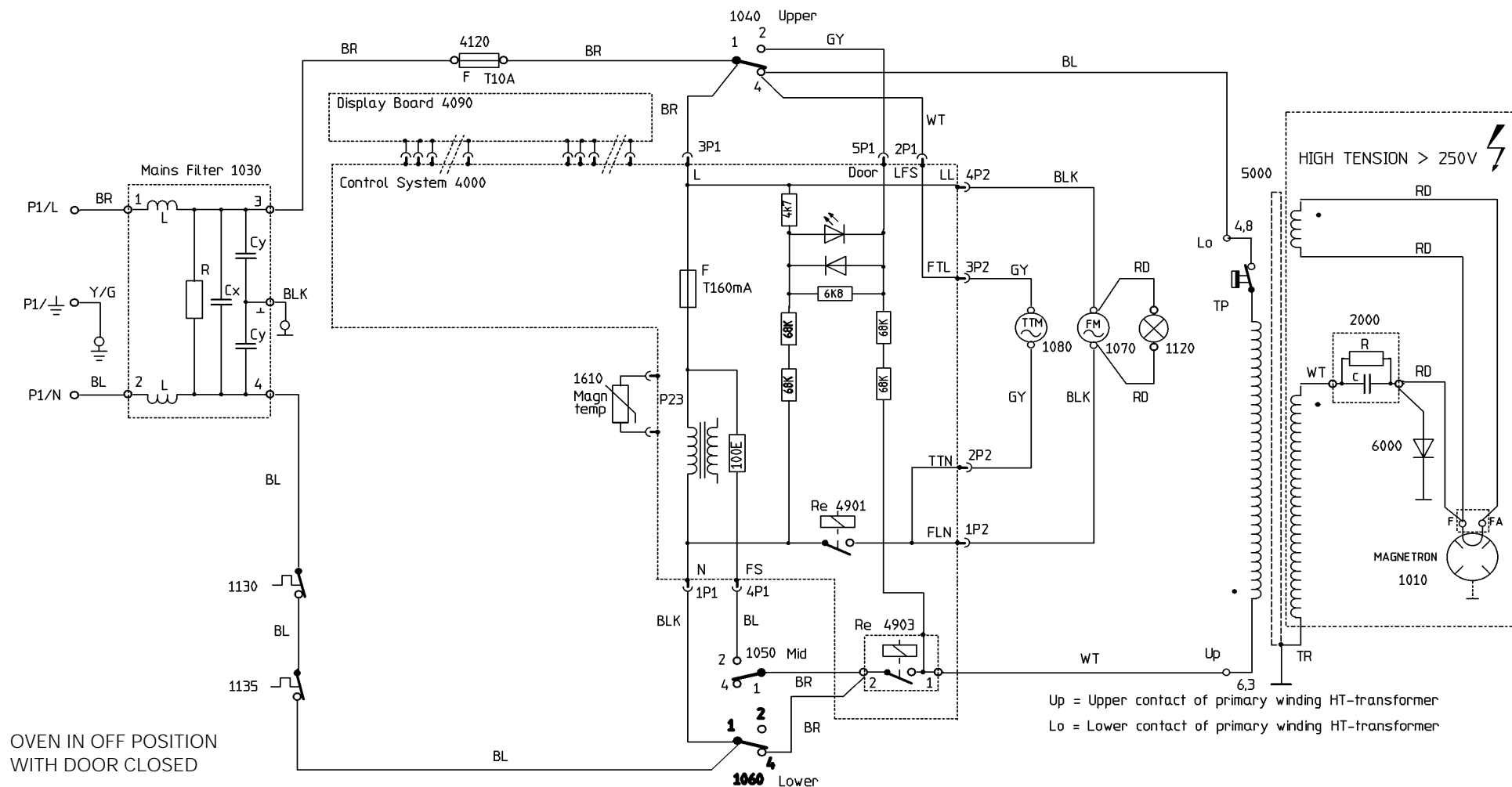

8587 450 99733

Wiring diagram

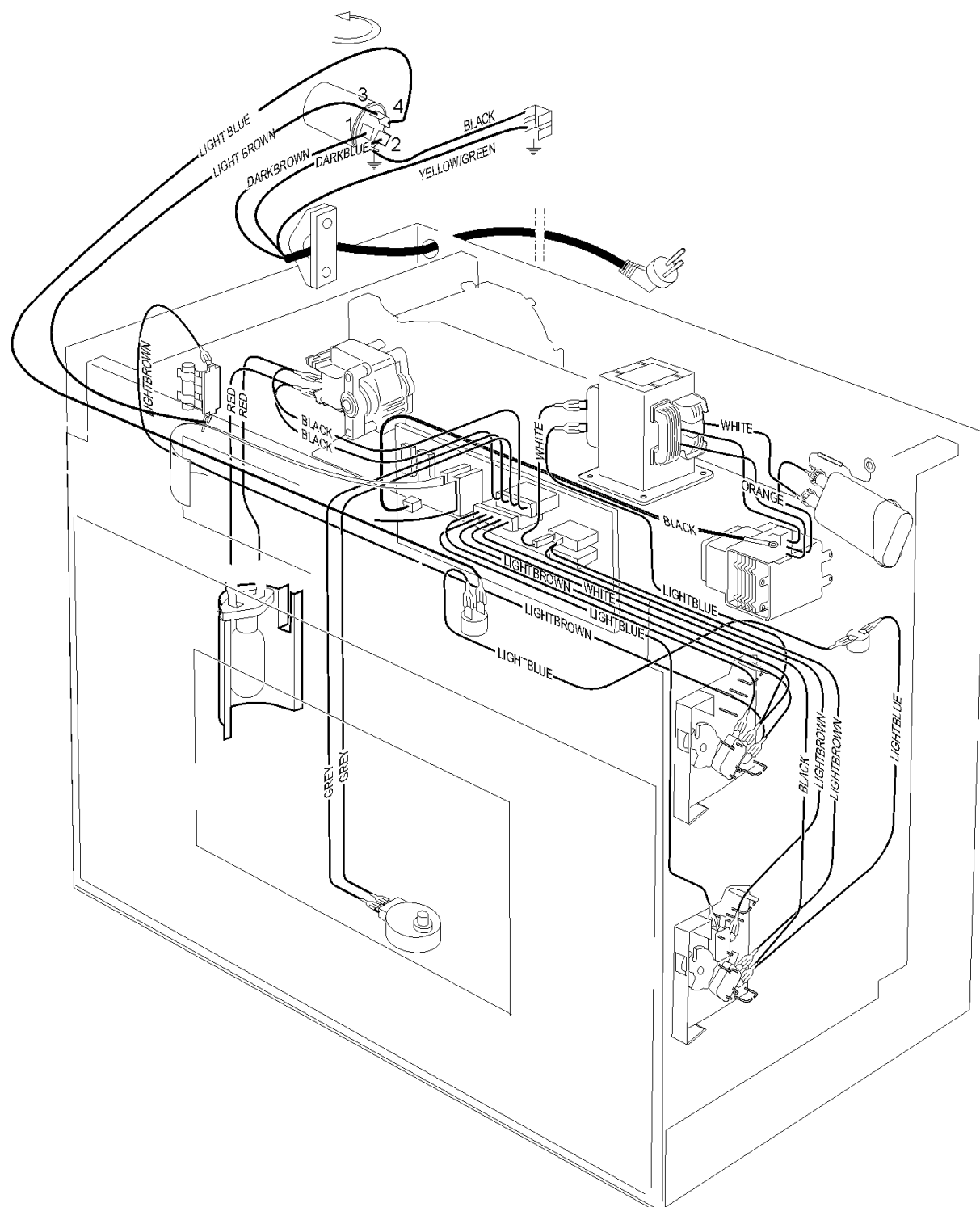

80000608